

ISS.	AMEND	DATE
1	ISSUED	07/01/21

DUAL MOUNT
CAN BE FRONT OR REAR MOUNTED

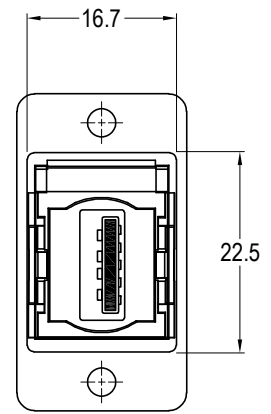
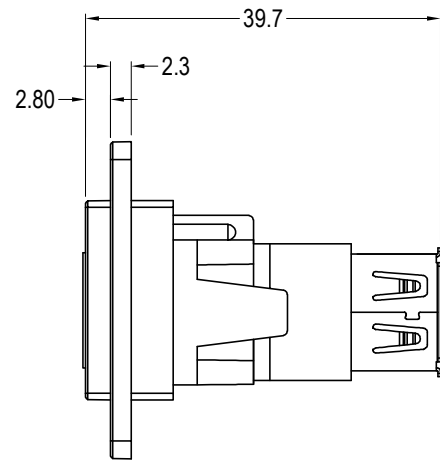
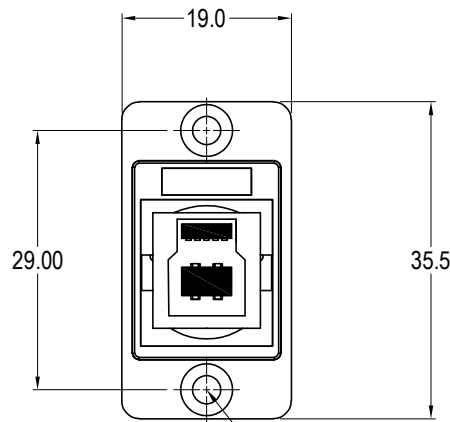
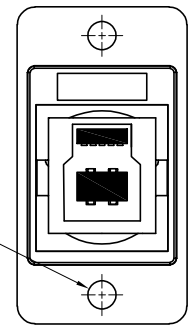
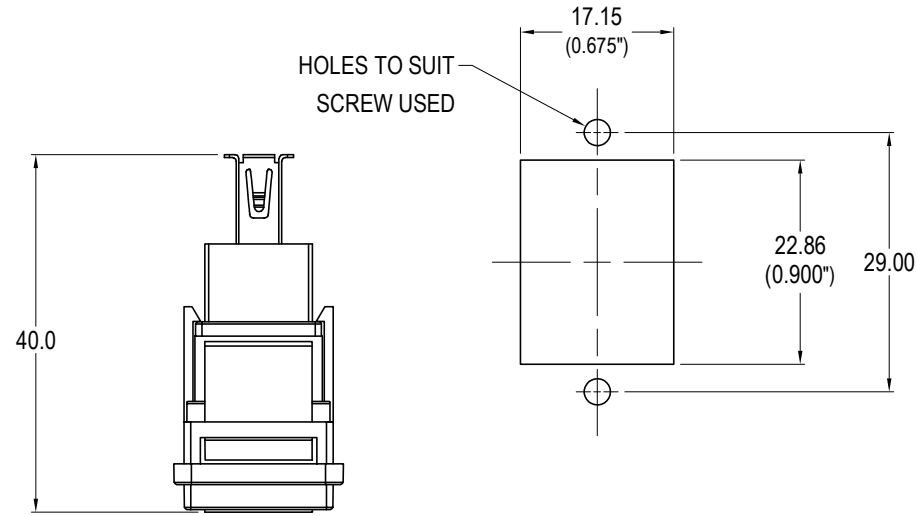

Ø3.20 PLAIN HOLE
CP30706NMBX1

VARIANTS	
PART NO.	HOLE DETAILS
CP30706NMB	HOLE Ø3.2 x CSK 90° x Ø5.85
CP30706NMB3	M3 HOLES
CP30706NMB440	#4-40 HOLES
CP30706NMBX1	PLAIN HOLE Ø3.2

4x HOLE VARIANTS
Ø3.2mm CSK 90° x Ø5.85
M3 x 0.5 THREAD
#4-40 UNC THREAD
PLAIN Ø3.2 HOLES

Specification:
 1. Voltage rating: 30V AC
 2. Current rating: 1.8A max
 3. Contact resistance: 50mΩ max
 4. Insulation resistance: 20MΩ min
 5. Dielectric withstanding voltage: 500V AC
 6. Operating Temperature: -20°C to 50°C

Material:
 1. Insert: ABS UL94 HB
 2. FT Frame: Diecast, Black
 3. Inner Overmouldings: PE + PVC
 4. Shell: Nickel plated steel
 5. Contacts: Gold Plated

RoHS

COMPLIANT

TOLERANCE
 NO DEC. PLACE ±
 1 DEC. PLACE ±
 2 DEC. PLACE ±
 HOLE Ø ±
 ANGLES ±
 UNLESS OTHERWISE STATED

Cliff Electronic Components Ltd.
 76 Holmethorpe Avenue, Holmethorpe Industrial Estate,
 Redhill, Surrey, RH1 2PF, England, UK
 Tel: 01737-771375 Fax: 01737-766012 Website: www.cliffuk.co.uk

DIMENSIONS IN MILLIMETERS UNLESS OTHERWISE STATED. WORK TO DIMENSIONS. REMOVE ALL BURRS. IF IN DOUBT ASK.

3rd ANGLE PROJECTION:

DO NOT SCALE

MATERIAL: See Notes

TITLE: DUAL BLACK METAL SLIM FT USB3 B-A

FINISH: See Notes

DRWG. No. **CP30706NMB** FORM: A4DRWGH