

Plug union, straight

STV-GE M5-AG 4

Part no.:10.08.02.00200

<https://www.schmalz.com/10.08.02.00200>

Homepage > Vacuum Technology for Automation > Vacuum Components > Filters and Connections > Hoses and Connectors > Screw in Push Fittings > STV-GE M5-AG 4

Push-in Fitting, straight



Thread G1: M5-M
 External hose diameter: 4 mm
 Material: Brass
 Surface: nickel plated
 Ambient temperature: -20 ... 80 °C

Design Data

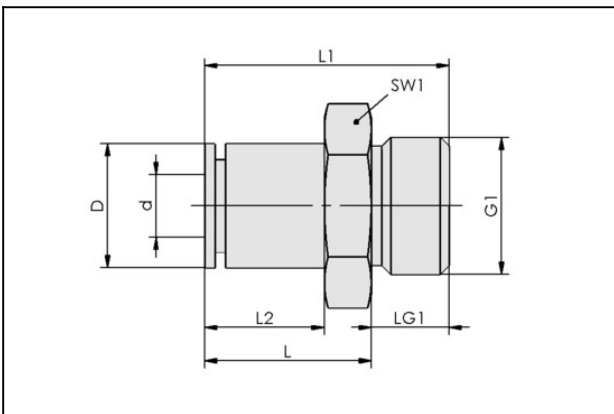

Attribute	Value
D	7.9 mm
d	4 mm
G1	M5-AG
dn	2 mm
L	15 mm
L1	19.5 mm
L2	11.4 mm
LG1	4.5 mm
SW1	8 mm

Technical Data

Plug union, straight

STV-GE M5-AG 4

Part no.:10.08.02.00200

<https://www.schmalz.com/10.08.02.00200>



Attribute	Value
Hose type	Schlauch D = 4 d = 2
Hose type	4-2
Material	Messing
Pressure range (operating pressure)	-0,95 ... 15,00 bar
Operating temperature	-20 ... 80 °C
Weight	5 g

Accessories

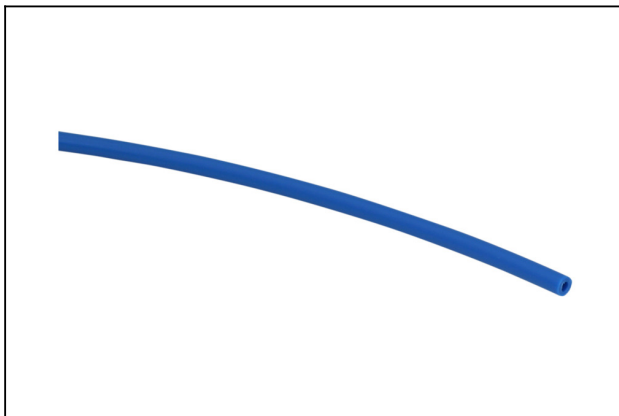

VSL 4-2 PE

Part no.10.07.09.00013

Hose for vacuum and compressed-air systems

External diameter D: 4 mm

Internal diameter d: 2 mm

Length (max): 100 m

Material: PE

Installation radius (min): 20 mm

Pressure range (operating pressure):

-0.95 ... 10.00 bar

Ambient temperature: -30 ... 70 °C



VSL 4-2 PU

Part no.10.07.09.00001

Hose for vacuum and compressed-air systems

External diameter D: 4 mm

Internal diameter d: 2 mm

Length (max): 50 m

Material: PU

Installation radius (min): 20 mm

Pressure range (operating pressure):

-0.95 ... 10.00 bar

Ambient temperature: -40 ... 60 °C

Plug union, straight

STV-GE M5-AG 4

Part no.:10.08.02.00200

<https://www.schmalz.com/10.08.02.00200>



VSL 4-2.7 PA

Part no.10.07.09.00063

Hose for vacuum and compressed-air systems

External diameter D: 4 mm

Internal diameter d: 2.7 mm

Length (max): 50 m

Material: PA

Installation radius (min): 30 mm

Pressure range (operating pressure):

-0.95 ... 20.00 bar

Ambient temperature: -40 ... 90 °C