

S100D / S125D

OPERATING MANUAL

Bulb Revolving Warning Light with Phone

Thank you for purchasing Q.Light product. Please read this manual carefully before installing this product for safe and long use.

1 Product Feature

- Ensuring high revolving durability by applying a special power transmission system to minimize noise and wear which is gained a patent.
- Having a high tone signal sound Max. 105dB and can install at a small place easily.
- RPM: 120~140RPM.
- Material: Lens-AS, Body-ABS, Reflector-thermostable ABS
- Protection Class: IP54
- Each model has 5 sound tones built-in. Select a suitable sound tone for the purpose of use
- Certificate: CE

2 Specification & External View Drawing

1) S100D

General Specification

Model	Voltage	Current	Bulb			Weight	Color
S100D	DC12V	1.266A	12V10W	T16x3515S	9	1.05Kg	RED-R
	DC24V	0.766A	24V10W	T16x3515S	10		
	AC110V	0.187A	12V10W	T16x3515S	9	1.44Kg	AMBER-A
	AC220V	0.094A	12V10W	T16x3515S	9		
S125D	DC12V	1.266A	12V10W	T16x3515S	9	1.07Kg	GREEN-G
	DC24V	0.766A	24V10W	T16x3515S	10		
	AC110V	0.187A	12V10W	T16x3515S	9	1.46Kg	BLUE-B
	AC220V	0.094A	12V10W	T16x3515S	9		

S100D External View Drawing

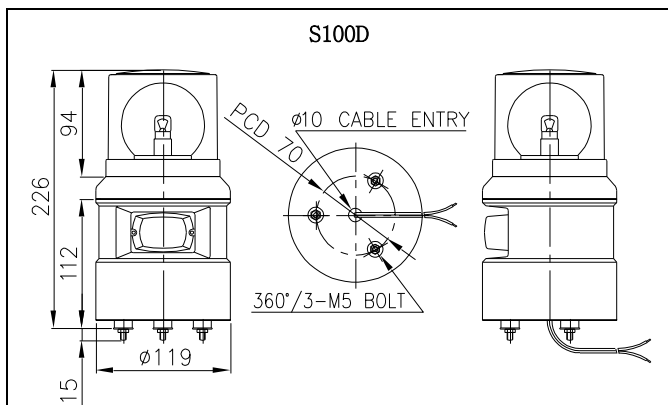

S125D External View Drawing

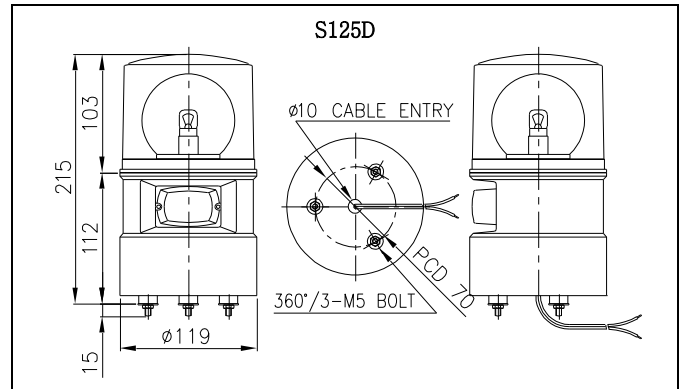

3 Sound Tone Combination of Standard Product

	Main Built-in Sounds	CH	Sound Tone	DB(Max)
WS	5Warning Sounds	ch1 ch2 ch3 ch4 ch5	Fire A-ANG Sound Emergency WA-U Sound Ambulance PI-PO Sound Machinery Fault PI-PI Sound High-Expasion Foamrelease PI-Sound	105dB
WM	5Melodies	ch1 ch2 ch3 ch4 ch5	Sweet Home For Elise Cuckoo Waltz Piano Sonata Turkish March	105dB
WA	5Alarms	ch1 ch2 ch3 ch4 ch5	Beep. intermittent Door chime Phone Ring sound PI.PI.PI. short interval Tripping bead sound	103dB
WV	3Voice Signals	Ch1 Ch2 Ch3	Voice recording 3 channels	95dB

4 Change Bulb

Please kindly follow below picture and instruction.

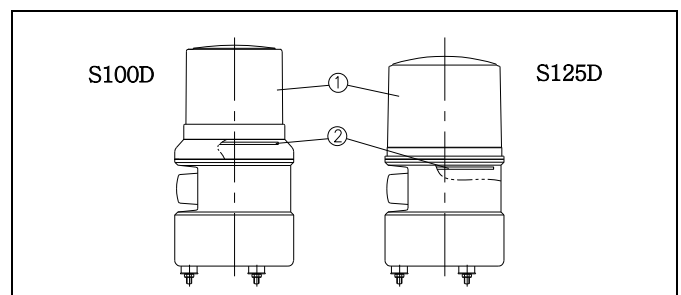

1) Lens Removal

Remove lens① by turning it counterclockwise, and make sure related parts(bulb etc.) on the assembling board②.

2) Bulb Change

- Must turn off power supply and change bulb after 1 minute at least.
- Make sure the rated voltage and wattage of new bulb. If the

voltage of new bulb is higher than original bulb, the life of product can be reduced and can cause damage on lens and reflector. Therefore, please use the bulb which has the same or lower rated voltage and wattage.

- **Bulb Removal:** Press slightly the bulb downward and turn it counterclockwise for removing.
- **Bulb Fitting:** Fit new bulb into the socket by pressing it clockwise.

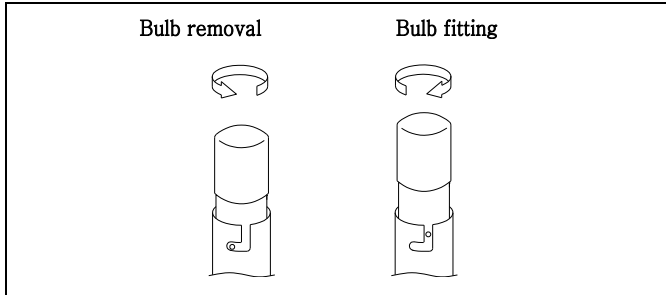

3) Lens Assembling

Assemble the product in reverse order of separating.

5 Wiring Instruction

Power lines and signal sound tone lines come out from the product. Please connect them correctly after referring to below instruction.

► Power line

- Power line: UL1015-NO.18(0.75sq) X 2c 400mm
- In case of product using AC voltage, connect the line without Polarity(wire color).
- In case of product using DC voltage, black line is negative(-).

► Signal line

- Signal line: UL1007-NO.22(0.3sq) 400mm

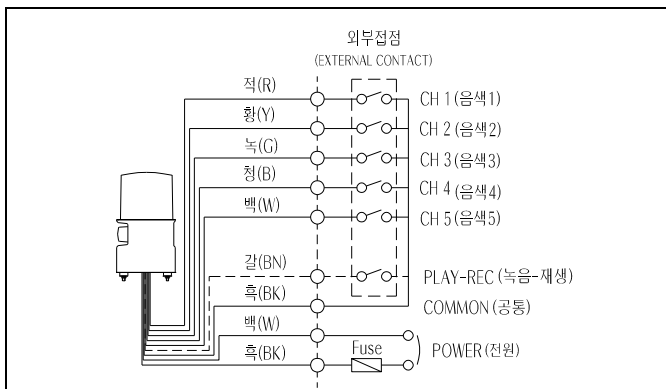

- Outdoor use is limited at a place where no water or very little water percolates. Mounting also should be done only on the vertical standing direction.
- Mount at the place where exists low vibration, low impact, low moisture and low dust as long as possible.
- Please make a hole by a drill where you need to attach our product and refer to below picture for a hole size. (Make sure PCD from external view drawing.)
- Fix the product by using nuts(M5-3EA) originally equipped on mounting bolt on bottom of the product.

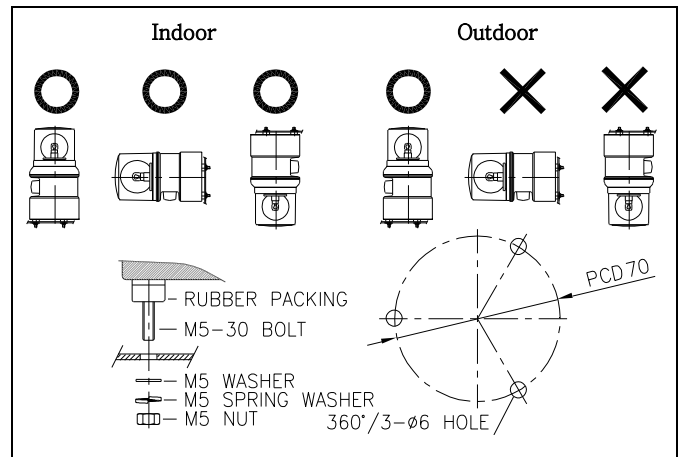

7 Caution

- If using voltage is seriously higher or lower than rated voltage, it can reduce the self-life of the product or can cause a problem on product operating. Make sure the using voltage does not exceed $\pm 5\%$ of the rated voltage.
- If lens or body of the product is contaminated by chemicals such as thinner, benzene, the product can be damaged, discolored or deformed. Please be careful.
- Do not give strong impact to the product. It can be a reason of wire disconnection or short circuit.
- In case of product using AC voltage, do not allow power supply either to common line or signal line.

6 Mounting

- This product was manufactured with the structure for indoor use. Installing in any direction is okay for indoor use.

8 Trouble shooting

Situation	Main reason	Solution
Non-lighting	Bulb mis-connecting	Bulb change
Feeble Lighting &Revolving, twisted sound tone	Supplying Voltage Lower than Rated Voltage	Making Sure Using Voltage
Short Self-Life of Bulb	Supplying Voltage Higher than Rated Voltage	Making Sure Using Voltage
Defect of transformer(AC Voltage Type)	Using the bulb over rated capacity change	Change the rated capacity bulb
Non Revolving	Problem with Motor	Contact Q.Light or Their Agent
Over-volume sound	Supplying Voltage Higher than Rated Voltage	Making Sure Using Voltage
Output 2 kinds of sounds	Signal sound line short	Making Sure connection
	Problem Sound tone Selection Switch	Contact Q.Light or Their Agent
No sound	Problem with Horn	Contact Q.Light or Their Agent
	Wrong Wiring	Making Sure connection

— For A/S & Information on Product

Q-LIGHT CO., LTD.

<http://www.qlightkr.com>

E-mail : qlightkr@qlightkr.com

Overseas Marketing Team /Plant

Tel) 055-328-4082Fax)055-328-4083

178-1 Woogyae-Ri, Sangdong-Myun, Kimhae-Si,
KyungNam, Korea