



## Sealtite HCX black: Robust, extreme temperature range.

Sealtite HCX offers excellent protection for cables at very low and very high temperatures. This robust, yet flexible conduit is typically used in transformers, offshore applications, steelworks, foundries, machine building and many outdoor installations where the conduit has to have temperature resistant properties.

### Material & Construction:

**Construction:** Galvanised steel core, square-locked with cord packing, thick smooth thermoplastic cover (TPE compound).

From 1.1/2" a fully inter-locked profile will be used.

**Cover specifications:** TPE, lead-free according to RoHS, sunlight and UV resistant. Suitable for outside installation.

**Temperature:** -55 °C to +145 °C, intermittent up to +160 °C.

**Colour:** Black.

### Classification according to NEN-EN-IEC 61386:

**Compression resistance:** Class 4, Heavy (1250 N).

**Impact resistance:** Class 4, Heavy (6 J).

**Tensile strength:** Class 4, Heavy (1000 N).

**Protection class:** IP 67 (dust-proof, water-tight).



Square locked

ANACONDA  
SEALTITE®

CONDUIT  
TYPE HCX  
BLACK

Sealtite	Diameter		Bending radius		Standard carton		Small carton		Reels		Weight
Size	Inside	Outside	Static	Dynamic	Metre	Article No.	Metre	Article No.	Metre	Article No.	(Kg/m)
(Inch)	(mm)	(mm)	(mm)	(mm)		<b>Black</b>		<b>Black</b>		<b>Black</b>	
5/16"	-	-	-	-	-	-	-	-	-	-	-
3/8"	12,6	17,8	60	85	<b>30</b>	<b>326.012.1</b>	10	326.012.3	250	326.012.5	0,3
1/2"	16,0	21,1	75	110	<b>30</b>	<b>326.016.1</b>	10	326.016.3	150	326.016.5	0,4
3/4"	21,0	26,4	90	140	<b>30</b>	<b>326.020.1</b>	10	326.020.3	120	326.020.5	0,6
1"	26,5	33,1	120	170	<b>30</b>	<b>326.026.1</b>	10	326.026.3	90	326.026.5	0,8
1.1/4"	35,1	41,8	135	215	<b>15</b>	<b>326.035.1</b>	-	-	60	326.035.5	1,1
1.1/2"	40,3	47,8	165	250	<b>15</b>	<b>326.040.1</b>	-	-	45	326.040.5	1,5
2"	51,6	59,9	210	300	<b>15</b>	<b>326.050.1</b>	-	-	30	326.050.5	2,0

\* Also available with stainless steel innercore (see chapter 4, type HCXI).

The fittings for Sealtite are outlined in chapter 5 (pages 1 till 29).



Size Sealtite	Inch	1/4"	5/16"	3/8"	1/2"	3/4"	1"	1 1/4"	1 1/2"	2"	2 1/2"	3"	4"
Fittings	ISO	M12-M16	M16-M20	M16-M20	M20	M25	M32	M40	M50	M63	M75	M90	M105
	PG	7	9 - 11	11 - 13,5	16	21	29	36	42	48	-	-	-
	NPT	-	-	1/2"	1/2"	3/4"	1"	1 1/4"	1 1/2"	2"	2 1/2"	3"	4"



## Anaconda compact fittings, UL & CSA, nickel plated brass, for Anaconda Sealtite.

The compact version nickel plated brass Anaconda fittings can be used with all types of Anaconda Sealtite (except CNP). This Anaconda fitting is a universal fitting with shorter design and lower weight. All ferrules are flanged versions for a better fit. The high quality nickel plating offers excellent corrosion protection in combination with a nice appearance. The compact fittings have UL & CSA approval.

**Construction:** Nickel plated brass fitting, consisting of 4 parts (counter nut, clamping ring, ferrule and body).

**Material:** Counter nut and body are nickel plated brass. Clamping ring is made from PA6 and the ferrule is made



from galvanised steel. The O-rings are from NBR rubber (black for ISO and blue for Pg).

**Special approvals:** UL-514B and CSA C 22.2 (combined UL/CSA file # E 234207).

Suitable for use in hazardous environments according NEC:

- Article 501.10 (B) (2) Class I, Division 2

- Article 502.10 (A) (2) and (B) (2) Class II, Division 1 and 2

- Article 503.10 (A) (3) and (B) Class III, Division 1 and 2

**Temperature:** -45 °C till +105 °C continuous

**Protection class:** IP 67 (dust-proof, water-tight)

**Colour:** Metal

### ISO straight fitting, compact, male, nickel plated brass.

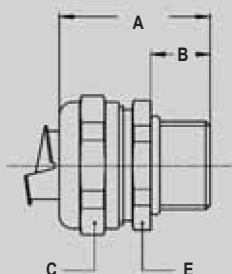

Thread	Sealtite	Min. Internal	Dimensions in mm					Standard	Article	Weight
ISO	Size (inch)	Bore (mm)	A	B	C	D	E	Package	Number	(Kg/100)
M16 x 1,5	3/8"	11,0	31	10	26	-	24	10	712.016.1	3,9
M20 x 1,5	3/8"	11,0	31	10	26	-	24	10	712.017.1	4,0
M20 x 1,5	1/2"	14,5	32	10	29	-	27	10	712.020.1	4,4
M25 x 1,5	3/4"	19,4	33	10	35	-	33	5	712.025.1	6,6
M32 x 1,5	1"	24,7	36	12	45	-	42	5	712.032.1	11,7
M40 x 1,5	1.1/4"	33,3	40	13	53	-	50	2	712.040.1	16,0
M50 x 1,5	1.1/2"	38,0	46	14	62	-	58	2	712.050.1	25,3
M63 x 1,5	2"	49,0	52	16	76	-	72	2	712.063.1	38,6

### ISO 45° fitting, compact, male, nickel plated brass.

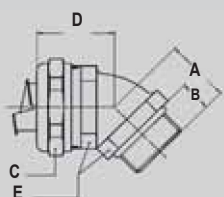

Thread	Sealtite	Min. Internal	Dimensions in mm					Standard	Article	Weight
ISO	Size (inch)	Bore (mm)	A	B	C	D	E	Package	Number	(Kg/100)
M16 x 1,5	3/8"	11,0	19	10	26	27	22	10	712.416.1	6,3
M20 x 1,5	3/8"	11,0	20	10	26	28	24	10	712.417.1	7,2
M20 x 1,5	1/2"	14,5	21	10	29	30	27	10	712.420.1	8,3
M25 x 1,5	3/4"	19,4	23	10	35	33	33	5	712.425.1	12,8
M32 x 1,5	1"	24,7	28	12	45	38	42	5	712.432.1	22,5



**ISO 90° fitting, compact, male, nickel plated brass.**



Thread	Sealtite Size (inch)	Min. Internal Bore (mm)	Dimensions in mm					Standard Package	Article Number	Weight (Kg/100)
			A	B	C	D	E			
M16 x 1,5	3/8"	11,0	26	10	26	31	22	10	712.916.1	6,6
M20 x 1,5	3/8"	11,0	26	10	26	32	24	10	712.917.1	7,9
M20 x 1,5	1/2"	14,5	28	10	29	34	27	10	712.920.1	9,2
M25 x 1,5	3/4"	19,4	32	10	35	40	33	5	712.925.1	16,2
M32 x 1,5	1"	24,7	40	12	45	49	42	5	712.932.1	27,8
M40 x 1,5	1.1/4"	33,3	46	13	53	53	52	2	712.940.1	40,1
M50 x 1,5	1.1/2"	38,0	52	14	62	57	60	2	712.950.1	57,5
M63 x 1,5	2"	49,0	62	16	76	68	72	2	712.963.1	90,6

**Pg straight fitting, compact, male, nickel plated brass.**

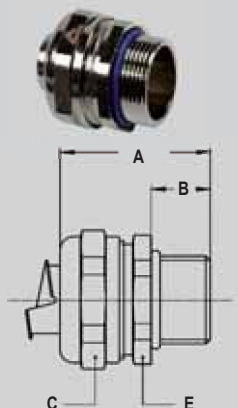

Thread	Sealtite Size (inch)	Min. Internal Bore (mm)	Dimensions in mm					Standard Package	Article Number	Weight (Kg/100)
			A	B	C	D	E			
Pg 11	3/8"	11,0	31	10	26	-	24	10	710.011.1	4,0
Pg 13,5	3/8"	11,0	31	10	26	-	24	10	710.013.1	4,2
Pg 16	1/2"	14,5	32	10	29	-	27	10	710.016.1	4,5
Pg 21	3/4"	19,4	33	10	35	-	33	5	710.021.1	6,5
Pg 29	1"	24,7	36	12	45	-	44	5	710.029.1	12,2
Pg 36	1.1/4"	33,3	40	13	53	-	52	2	710.036.1	16,4
Pg 42	1.1/2"	38,0	46	14	62	-	60	2	710.042.1	26,3
Pg 48	2"	49,0	52	16	76	-	72	2	710.048.1	38,6

**Pg 90° fitting, compact, male, nickel plated brass.**



Thread	Sealtite Size (inch)	Min. Internal Bore (mm)	Dimensions in mm					Standard Package	Article Number	Weight (Kg/100)
			A	B	C	D	E			
Pg 11	3/8"	11,0	26	10	26	32	24	10	710.911.1	7,7
Pg 13,5	3/8"	11,0	26	10	26	32	24	10	710.913.1	8,0
Pg 16	1/2"	14,5	28	10	29	34	27	10	710.916.1	9,2
Pg 21	3/4"	19,4	32	10	35	40	33	5	710.921.1	15,7
Pg 29	1"	24,7	40	12	45	49	42	5	710.929.1	28,6
Pg 36	1.1/4"	33,3	46	13	53	53	52	2	710.936.1	40,1
Pg 42	1.1/2"	38,0	52	14	62	57	60	2	710.942.1	57,5
Pg 48	2"	49,0	62	16	76	68	72	2	710.948.1	92,1

**NPT straight fitting, compact, male, nickel plated brass.**

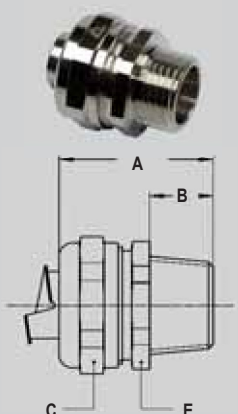

Thread	Sealtite Size (inch)	Min. Internal Bore (mm)	Dimensions in mm					Standard Package	Article Number	Weight (Kg/100)
			A	B	C	D	E			
NPT 1/2"	3/8"	11,0	35	14	26	-	24	10	714.012.1	4,4
NPT 1/2"	1/2"	14,5	36	14	29	-	27	10	714.016.1	5,0
NPT 3/4"	3/4"	19,4	37	14	35	-	33	5	714.020.1	7,0
NPT 1"	1"	24,7	40	16	45	-	42	5	714.026.1	12,6
NPT 1.1/4"	1.1/4"	33,3	43	16	53	-	50	2	714.035.1	16,8
NPT 1.1/2"	1.1/2"	38,0	50	18	62	-	58	2	714.040.1	25,8
NPT 2"	2"	49,0	56	20	76	-	72	2	714.050.1	41,2

**ANACONDA  
COMPACT  
FITTINGS**

**LIQUID-TIGHT  
FITTINGS FOR  
SEALTITE  
IP 67**

### NPT 45° fitting, compact, male, nickel plated brass.



GOST-R RoHS



Thread	Sealtite	Min. Internal	Dimensions in mm					Standard	Article	Weight
NPT	Size (inch)	Bore (mm)	A	B	C	D	E	Package	Number	(Kg/100)
NPT 1/2"	3/8"	11,0	24	14	26	28	24	10	714.912.1	7,7
NPT 1/2"	1/2"	14,5	25	14	29	30	27	10	714.916.1	8,8
NPT 3/4"	3/4"	19,4	27	14	35	33	33	5	714.920.1	14,5
NPT 1"	1"	24,7	32	16	45	38	42	5	714.926.1	24,0

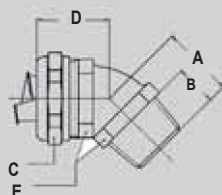

### NPT 90° fitting, compact, male, nickel plated brass.



GOST-R RoHS



Thread	Sealtite	Min. Internal	Dimensions in mm					Standard	Article	Weight
NPT	Size (inch)	Bore (mm)	A	B	C	D	E	Package	Number	(Kg/100)
NPT 1/2"	3/8"	11,0	30	14	26	32	24	10	714.912.1	8,2
NPT 1/2"	1/2"	14,5	32	14	29	34	27	10	714.916.1	9,6
NPT 3/4"	3/4"	19,4	36	14	35	40	33	5	714.920.1	16,7
NPT 1"	1"	24,7	44	16	45	49	42	5	714.926.1	28,3
NPT 1.1/4"	1.1/4"	33,3	49	16	53	53	52	2	714.935.1	41,4
NPT 1.1/2"	1.1/2"	38,0	56	18	62	57	60	2	714.940.1	57,3
NPT 2"	2"	49,0	66	20	76	68	72	2	714.950.1	90,8

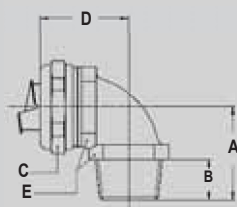

### NPT straight fitting, compact, male, nickel plated brass, including washer and locknut



GOST-R RoHS



Thread	Sealtite	Min. Internal	Dimensions in mm					Standard	Article	Weight
NPT	Size (inch)	Bore (mm)	A	B	C	D	E	Package	Number	(Kg/100)
NPT 1/2"	3/8"	11,0	35	14	26	-	24	10	714.012.2	4,9
NPT 1/2"	1/2"	14,5	36	14	29	-	27	10	714.016.2	5,5
NPT 3/4"	3/4"	19,4	37	14	35	-	33	5	714.020.2	7,8
NPT 1"	1"	24,7	40	16	45	-	42	5	714.026.2	13,9
NPT 1.1/4"	1.1/4"	33,3	43	16	53	-	50	2	714.035.2	18,6
NPT 1.1/2"	1.1/2"	38,0	50	18	62	-	58	2	714.040.2	28,0
NPT 2"	2"	49,0	56	20	76	-	72	2	714.050.2	44,0

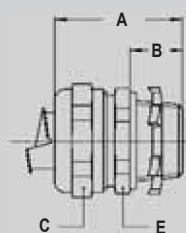

### NPT 90° fitting, compact, male, nickel plated brass, including washer and locknut



GOST-R RoHS



Thread	Sealtite	Min. Internal	Dimensions in mm					Standard	Article	Weight
NPT	Size (inch)	Bore (mm)	A	B	C	D	E	Package	Number	(Kg/100)
NPT 1/2"	3/8"	11,0	30	14	26	32	24	10	714.912.2	8,7
NPT 1/2"	1/2"	14,5	32	14	29	34	27	10	714.916.2	10,1
NPT 3/4"	3/4"	19,4	36	14	35	40	33	5	714.920.2	16,6
NPT 1"	1"	24,7	44	16	45	49	42	5	714.926.2	29,6
NPT 1.1/4"	1.1/4"	33,3	49	16	53	53	52	2	714.935.2	43,2
NPT 1.1/2"	1.1/2"	38,0	56	18	62	57	60	2	714.940.2	59,5
NPT 2"	2"	49,0	66	20	76	68	72	2	714.950.2	93,6

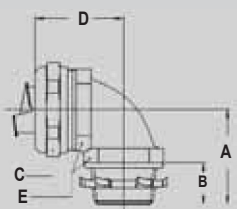

## ANACONDA COMPACT FITTINGS

## LIQUID-TIGHT FITTINGS FOR SEALTITE IP 67



### Anaconda swivel fittings, nickel plated brass, for Anaconda Sealtite.

The swivel version nickel plated brass Anaconda fittings can be used with all types of Anaconda Sealtite (except CNP). This Anaconda fitting is a universal fitting with a special swivel mechanism for a higher tensile strength and a high water proof protection (IP67). All ferrules are turned nickel plated brass versions for a better fit. The high quality nickel plating offers excellent corrosion protection in combination with a nice appearance.



**Construction:** Nickel plated brass fitting, consisting of 4 parts (counter nut, clamping ring, ferrule and body).

**Material:** Counter nut and body are nickel plated brass. Clamping ring is made from PA6 and the ferrule is made from nickel plated brass. The O-rings are from NBR rubber (black for ISO).

**Temperature:** -45 °C till +105 °C continuous

**Protection class:** IP 67

**Colour:** Metal

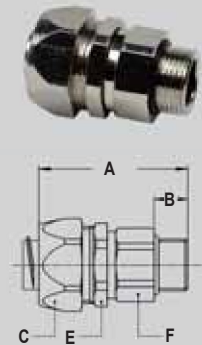

### ISO straight swivel fitting, male, nickel plated brass



Thread	Sealtite	Min. Internal	Dimensions in mm						Standard	Article	Weight
ISO	Size (inch)	Bore (mm)	A	B	C	E	F	Package		Number	(Kg/100)
M16 x 1,5	5/16"	8,3	48	10	26	24	21	10		813.015.0	8,1
M16 x 1,5	3/8"	10,4	48	10	26	24	21	10		813.016.0	8,1
M20 x 1,5	1/2"	13,8	49	10	29	27	25	10		813.020.0	10,2
M25 x 1,5	3/4"	17,4	49	10	35	33	31	5		813.025.0	13,8
M32 x 1,5	1"	23,4	55	12	45	42	38	5		813.032.0	32,5
M40 x 1,5	1.1/4"	29,4	58	14	54	50	48	2		813.040.0	53,0
M50 x 1,5	1.1/2"	36,9	65	14	62	58	55	2		813.050.0	74,0
M63 x 1,5	2"	47,9	74	16	76	72	68	2		813.063.0	130,0

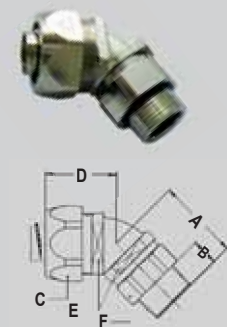

### ISO 45° swivel fitting, male, nickel plated brass.



Thread	Sealtite	Min. Internal	Dimensions in mm						Standard	Article	Weight
ISO	Size (inch)	Bore (mm)	A	B	C	D	E	F	Package	Number	(Kg/100)
M16 x 1,5	3/8"	10,4	34	10	26	28	22	21	10	813.416.0	9,5
M20 x 1,5	1/2"	13,8	34	10	29	30	27	25	10	813.420.0	13,5
M25 x 1,5	3/4"	17,4	37	10	35	32	33	31	5	813.425.0	21,5
M32 x 1,5	1"	23,4	41	12	45	37	42	38	5	813.432.0	36,5

### ISO 90° swivel fitting, male, nickel plated brass

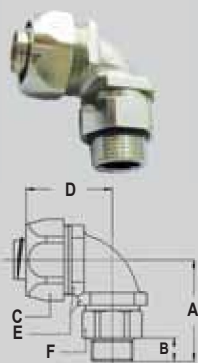

Thread	Sealtite	Min. Internal	Dimensions in mm						Standard	Article	Weight
ISO	Size (inch)	Bore (mm)	A	B	C	D	E	F	Package	Number	(Kg/100)
M16 x 1,5	5/16"	8,3	39	10	26	35	22	21	10	813.915.0	10,8
M16 x 1,5	3/8"	10,4	39	10	26	35	22	21	10	813.916.0	10,8
M20 x 1,5	1/2"	13,8	39	10	29	37	27	25	10	813.920.0	13,2
M25 x 1,5	3/4"	17,4	46	10	35	44	33	31	5	813.925.0	22,8
M32 x 1,5	1"	23,4	55	12	45	55	42	38	5	813.932.0	41,4

### NPT 45° swivel fitting, male, nickel plated brass

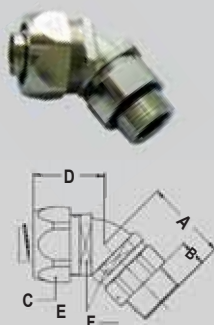

Thread	Sealtite	Min. Internal	Dimensions in mm						Standard	Article	Weight
NPT	Size (inch)	Bore (mm)	A	B	C	D	E	F	Package	Number	(Kg/100)
NPT 1/2"	3/8"	10,4	36	12	26	28	22	22	10	819.412.0	11,5
NPT 1/2"	1/2"	13,8	36	12	29	30	27	25	10	819.416.0	14,0
NPT 3/4"	3/4"	17,4	39	12	35	32	33	31	5	819.420.0	22,0
NPT 1"	1"	23,4	42	13	45	37	42	38	5	819.426.0	37,0

### NPT 90° swivel fitting, male, nickel plated brass

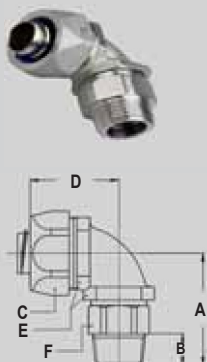

Thread	Sealtite	Min. Internal	Dimensions in mm						Standard	Article	Weight
NPT	Size (inch)	Bore (mm)	A	B	C	D	E	F	Package	Number	(Kg/100)
NPT 1/2"	3/8"	10,4	41	12	26	35	22	22	10	819.912.0	12,0
NPT 1/2"	1/2"	13,8	41	12	29	37	27	25	10	819.916.0	14,0
NPT 3/4"	3/4"	17,4	48	12	35	44	33	31	5	819.920.0	23,5
NPT 1"	1"	23,4	56	13	45	55	42	38	5	819.926.0	42,0

**ANACONDA  
COMPACT  
FITTINGS**

**LIQUID-TIGHT  
FITTINGS FOR  
SEALTITE  
IP 67**



## ANACONDA FITTINGS

## LIQUID-TIGHT FITTINGS FOR SEALTITE IP 67



### Anaconda nickel plated brass fittings for Anaconda Sealtite.

The nickel plated brass Anaconda fittings can be used with all types of Anaconda Sealtite (except CNP). This Anaconda fitting is the most used universal fitting and offers great corrosion protection in combination with a nice appearance. Because of the UL & CSA approvals the fittings are also suitable for export projects outside Europe.

**Construction:** Nickel plated brass fitting, consisting of 4 parts (counter nut, clamping ring, ferrule and body).

**Material:** Counter nut, body and ferrule are nickel plated brass with exception of size 3/8" till 1" where the ferrule is from galvanised steel. Clamping ring and inserts are made

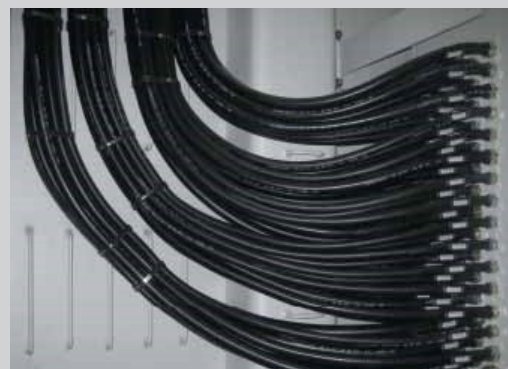

from PA6 (red for ISO metric, blue for Pg and white for NPT).  
**Special approvals:** UL-514B and CSA C 22.2 (combined UL/CSA file # E 234207).

Suitable for use in hazardous environments according NEC:

- Article 501.10 (B) (2) Class I, Division 2
- Article 502.10 (A) (2) and (B) (2) Class II, Division 1 and 2
- Article 503.10 (A) (3) and (B) Class III, Division 1 and 2

**Temperature:** -45 °C till +105 °C continuous (cable-hose-fittings are -40 °C till +100 °C).

**Protection class:** IP 67 (dust-proof, water-tight), with cable-hose fittings an IP 68 rate on the switchbox can be obtained. Swivel fittings are limited to IP 65. **Colour:** Metal.



### ISO straight fitting, male, nickel plated brass.

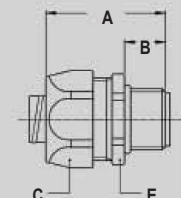
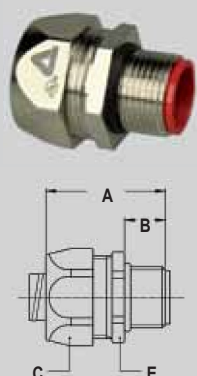

Thread	Sealtite	Min. Internal	Dimensions in mm					Standard	Article	Weight
ISO	Size (inch)	Bore (mm)	A	B	C	D	E	Package	Number	(Kg/100)
M12 x 1,5	1/4"	5,2	33	10	22	-	20	10	812.012.1*	4,8
M16 x 1,5	5/16"	8,3	35	12	26	-	24	10	812.015.1*	4,8
M20 x 1,5	5/16"	8,3	36	13	26	-	24	10	812.014.1*	5,1
M16 x 1,5	3/8"	10,2	35	12	26	-	24	10	812.016.1	4,8
M20 x 1,5	3/8"	10,2	36	13	26	-	24	10	812.017.1	5,1
M20 x 1,5	1/2"	13,9	37	13	29	-	27	10	812.020.1	5,9
M25 x 1,5	3/4"	18,5	40	15	35	-	33	5	812.025.1	7,9
M32 x 1,5	1"	23,8	46	15	45	-	43	5	812.032.1	17,5
M40 x 1,5	1.1/4"	31,8	52	16	54	-	52	2	812.040.1	27,9
M50 x 1,5	1.1/2"	36,8	56	18	63	-	60	2	812.050.1	42,3
M63 x 1,5	2"	47,8	66	20	77	-	74	2	812.063.1	73,5
M75 x 1,5	2.1/2"	59,0	72	24	95	-	90	1	812.075.1*	134,4

\* Fittings for 1/4", 5/16" and 2.1/2" conduit without UL/CSA approval.

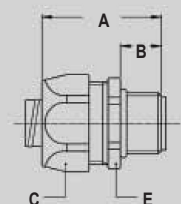
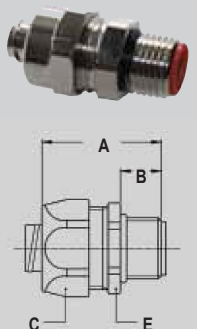

### ISO straight fitting, small design, male, nickel plated brass.



Thread	Sealtite	Min. Internal	Dimensions in mm					Standard	Article	Weight
ISO	Size (inch)	Bore (mm)	A	B	C	D	E	Package	Number	(Kg/100)
M12 x 1,5	1/4"	5,2	33	10	19	-	17	10	812.012.2	2,8
M16 x 1,5	1/4"	5,2	35	12	19	-	19	10	812.013.2	3,4
M12 x 1,5	5/16"	8,3	33	10	22	-	20	10	812.011.2	3,6
M16 x 1,5	5/16"	8,3	35	12	22	-	20	10	812.015.2	3,8
M20 x 1,5	5/16"	8,3	36	13	22	-	24	10	812.014.2	4,2

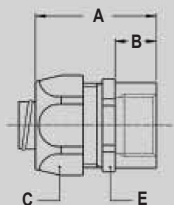

### ISO straight fitting, female, nickel plated brass.



Thread	Sealtite	Min. Internal	Dimensions in mm					Standard	Article	Weight
ISO	Size (inch)	Bore (mm)	A	B	C	D	E	Package	Number	(Kg/100)
M16 x 1,5	5/16"	8,3	35	12	26	-	24	10	812.315.1*	5,0
M16 x 1,5	3/8"	10,2	35	12	26	-	24	10	812.316.1	5,0
M20 x 1,5	1/2"	13,9	37	13	29	-	27	10	812.320.1	7,6
M25 x 1,5	3/4"	18,5	40	15	35	-	33	5	812.325.1	9,0
M32 x 1,5	1"	23,8	46	15	45	-	43	5	812.332.1	18,3
M40 x 1,5	1.1/4"	31,8	52	16	54	-	52	2	812.340.1	29,3
M50 x 1,5	1.1/2"	36,8	56	18	63	-	60	2	812.350.1	41,2
M63 x 1,5	2"	47,8	66	20	77	-	74	2	812.363.1	71,8

\* Fittings for 5/16" conduit without UL/CSA approval.



### ISO 45° fitting, male, nickel plated brass.

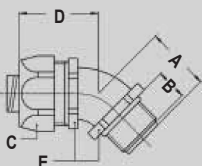

Thread	Sealtite	Min. Internal	Dimensions in mm					Standard	Article	Weight
ISO	Size (inch)	Bore (mm)	A	B	C	D	E	Package	Number	(Kg/100)
M16 x 1,5	5/16"	8,3	23	12	26	33	22	10	812.415.1*	7,3
M20 x 1,5	5/16"	8,3	24	13	26	33	22	10	812.414.1*	7,4
M16 x 1,5	3/8"	10,2	23	12	26	33	22	10	812.416.1	7,3
M20 x 1,5	3/8"	10,2	24	13	26	33	22	10	812.417.1	7,4
M20 x 1,5	1/2"	13,9	25	13	29	33	27	10	812.420.1	10,5
M25 x 1,5	3/4"	18,5	30	15	35	36	33	5	812.425.1	13,6
M32 x 1,5	1"	23,8	34	15	45	46	42	5	812.432.1	26,5
M40 x 1,5	1.1/4"	31,8	39	16	54	54	51	2	812.440.1	44,9
M50 x 1,5	1.1/2"	36,8	45	18	63	59	60	2	812.450.1	67,5
M63 x 1,5	2"	47,8	53	20	77	71	74	2	812.463.1	128,0

\* Fittings for 5/16" conduit without UL/CSA approval.



### ISO 90° fitting, male, nickel plated brass.

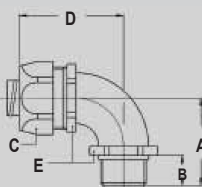

Thread	Sealtite	Min. Internal	Dimensions in mm					Standard	Article	Weight
ISO	Size (inch)	Bore (mm)	A	B	C	D	E	Package	Number	(Kg/100)
M16 x 1,5	5/16"	8,3	32	12	26	42	22	10	812.915.1*	8,2
M20 x 1,5	5/16"	8,3	33	13	26	42	22	10	812.914.1*	8,4
M16 x 1,5	3/8"	10,2	32	12	26	42	22	10	812.916.1	8,2
M20 x 1,5	3/8"	10,2	33	13	26	42	22	10	812.917.1	8,4
M20 x 1,5	1/2"	13,9	36	13	29	43	27	10	812.920.1	12,6
M25 x 1,5	3/4"	18,5	43	15	35	48	33	5	812.925.1	19,2
M32 x 1,5	1"	23,8	48	15	45	59	42	5	812.932.1	31,6
M40 x 1,5	1.1/4"	31,8	57	16	54	68	51	2	812.940.1	56,1
M50 x 1,5	1.1/2"	36,8	63	18	63	78	60	2	812.950.1	85,3
M63 x 1,5	2"	47,8	74	20	77	96	74	2	812.963.1	139,8

\* Fittings for 5/16" conduit without UL/CSA approval.

**ANACONDA  
FITTINGS**

**LIQUID-TIGHT  
FITTINGS FOR  
SEALTITE  
IP 67**

## ISO cable-hose fitting, male, nickel plated brass.

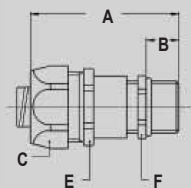

Thread	Sealtite	Clamping	Dimensions in mm					Standard	Article	Weight
ISO	Size (inch)	Range (mm)	A	B	C	E	F	Package	Number	(Kg/100)
M16 x 1,5	5/16"	4 - 8	57	12	26	24	18	10	812.715.2	5,2
M16 x 1,5	3/8"	4 - 8	57	12	26	24	18	10	812.716.1	7,8
M20 x 1,5	3/8"	6 - 10,2	57	12	26	24	22	10	812.717.1	9,5
M20 x 1,5	1/2"	6 - 12	59	12	29	27	22	10	812.720.1	9,7
M25 x 1,5	1/2"	10 - 13,9	62	12	29	27	27	10	812.722.1	11,7
M32 x 1,5	3/4"	13 - 18	70	15	35	33	34	5	812.728.1	20,2
M40 x 1,5	1"	18 - 23,5	83	15	45	43	43	2	812.735.1	32,6
M40 x 1,5	1.1/4"	22 - 31,5	96	15	54	52	43	2	812.740.1	46,0
M50 x 1,5	1.1/4"	22 - 31,8	96	15	54	52	55	2	812.745.1	60,0

## ISO, EMC cable-hose fitting, male, nickel plated brass.

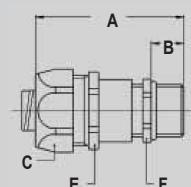

Thread	Sealtite	Clamping	Dimensions in mm					Standard	Article	Weight
ISO	Size (inch)	Range (mm)	A	B	C	E	F	Package	Number	(Kg/100)
M16 x 1,5	5/16"	4 - 8	57	12	26	24	18	10	812.615.2	5,2
M16 x 1,5	3/8"	4 - 8	57	12	26	24	18	10	812.616.1	7,8
M20 x 1,5	3/8"	6 - 10,2	57	12	26	24	22	10	812.617.1	9,5
M20 x 1,5	1/2"	6 - 12	59	12	29	27	22	10	812.620.1	9,7
M25 x 1,5	1/2"	10 - 13,9	62	12	29	27	27	5	812.622.1	11,7
M32 x 1,5	3/4"	13 - 18	70	15	35	33	34	5	812.628.1	19,6
M40 x 1,5	1"	18 - 23,8	83	15	45	43	43	2	812.635.1	35,4

## ISO cable-hose fitting, with extended clamping range, male, nickel plated brass.

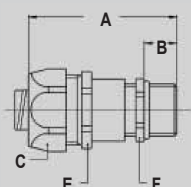

Thread	Sealtite	Clamping	Dimensions in mm					Standard	Article	Weight
ISO	Size (inch)	Range (mm)	A	B	C	E	F	Package	Number	(Kg/100)
M16 x 1,5	3/8"	3 - 10,2	64	12	26	24	20	10	812.716.2	8,2
M20 x 1,5	1/2"	7 - 13,9	64	12	29	27	24	10	812.720.2	10,2
M25 x 1,5	3/4"	9 - 18,0	77	15	35	33	30	5	812.725.2	17,0
M32 x 1,5	1"	13 - 23,8	88	15	45	43	40	5	812.732.2	31,0
M40 x 1,5	1.1/4"	20 - 31,8	102	15	54	52	50	2	812.740.2	54,6
M50 x 1,5	1.1/2"	21 - 36,8	106	18	63	60	58	2	812.750.2	76,6
M63 x 1,5	2"	27 - 44,0	116	18	77	74	68	2	812.763.2	116,6

## Multiple seals for cable hose fittings with extended range.



Thread	Sealtite	number of holes x diam. (mm)	Dimensions in mm					Standard	Article	Weight
ISO	Size (inch)		A	B	C	E	F	Package	Number	(Kg/100)
M20 x 1,5	1/2"	3 x 4,0	-	-	-	-	-	100	785.234.0	-
M20 x 1,5	1/2"	3 x 5,0	-	-	-	-	-	100	785.235.0	-
M20 x 1,5	1/2"	4 x 3,0	-	-	-	-	-	100	785.243.0	-
M20 x 1,5	1/2"	4 x 4,0	-	-	-	-	-	100	785.244.0	-
M25 x 1,5	3/4"	2 x 7,0	-	-	-	-	-	100	785.327.0	-
M25 x 1,5	3/4"	3 x 6,6	-	-	-	-	-	100	785.336.6	-
M25 x 1,5	3/4"	3 x 8,0	-	-	-	-	-	100	785.338.0	-
M32 x 1,5	1"	3 x 7,5	-	-	-	-	-	100	785.437.5	-
M32 x 1,5	1"	4 x 8,0	-	-	-	-	-	100	785.448.0	-
M32 x 1,5	1"	6 x 5,0	-	-	-	-	-	100	785.465.0	-
M32 x 1,5	1"	6 x 6,0	-	-	-	-	-	100	785.466.0	-

\* Other (not mentioned types) are available on request. The multiple seals will be delivered separately.

ANACONDA  
FITTINGS

LIQUID-TIGHT  
FITTINGS FOR  
SEALTITE  
IP 67



### Pg straight fitting, male, nickel plated brass.

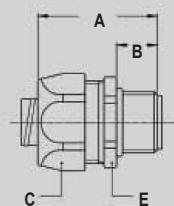

Thread	Sealtite	Min. Internal	Dimensions in mm					Standard	Article	Weight
Pg	Size (inch)	Bore (mm)	A	B	C	D	E	Package	Number	(Kg/100)
Pg 7	1/4"	5,2	33	10	22	-	20	10	810.007.1*	3,0
Pg 9	5/16"	8,3	35	12	26	-	24	10	810.009.1*	4,8
Pg 11	5/16"	8,3	35	12	26	-	24	10	810.012.1*	5,6
Pg 13,5	5/16"	8,3	35	12	26	-	24	10	810.014.1*	5,6
Pg 9	3/8"	10,2	35	12	26	-	24	10	810.010.1	4,8
Pg 11	3/8"	10,2	35	12	26	-	24	10	810.011.1	5,6
Pg 13,5	3/8"	10,2	35	12	26	-	24	10	810.013.1	5,6
Pg 16	1/2"	13,9	37	13	29	-	27	10	810.016.1	6,3
Pg 21	3/4"	18,5	40	15	35	-	33	5	810.021.1	8,4
Pg 29	1"	23,8	46	15	45	-	43	5	810.029.1	25,0
Pg 36	1.1/4"	31,8	52	16	54	-	52	2	810.036.1	34,6
Pg 42	1.1/2"	36,8	56	18	63	-	60	2	810.042.1	47,2
Pg 48	2"	47,8	66	20	77	-	74	2	810.048.1	72,0

\* Fittings for 1/4" and 5/16" conduit without UL/CSA approval.



### Pg straight fitting, small design, male, nickel plated brass.

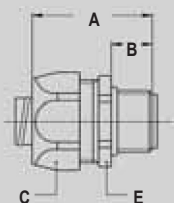

Thread	Sealtite	Min. Internal	Dimensions in mm					Standard	Article	Weight
Pg	Size (inch)	Bore (mm)	A	B	C	D	E	Package	Number	(Kg/100)
Pg 7	1/4"	5,2	33	10	19	-	17	10	810.007.2	2,8
Pg 9	5/16"	8,3	35	12	22	-	20	10	810.009.2	3,8



### Pg straight fitting, female, nickel plated brass.

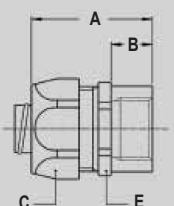

Thread	Sealtite	Min. Internal	Dimensions in mm					Standard	Article	Weight
Pg	Size (inch)	Bore (mm)	A	B	C	D	E	Package	Number	(Kg/100)
Pg 11	5/16"	8,3	35	12	26	-	24	10	810.312.1*	5,3
Pg 13,5	5/16"	8,3	35	12	26	-	24	10	810.314.1*	5,3
Pg 11	3/8"	10,2	35	12	26	-	24	10	810.311.1	5,3
Pg 13,5	3/8"	10,2	35	12	26	-	24	10	810.313.1	5,3
Pg 16	1/2"	13,9	37	13	29	-	27	10	810.316.1	6,3
Pg 21	3/4"	18,5	40	15	35	-	33	5	810.321.1	9,3
Pg 29	1"	23,8	46	15	45	-	43	5	810.329.1	20,7
Pg 36	1.1/4"	31,8	52	16	54	-	52	2	810.336.1	29,3
Pg 42	1.1/2"	36,8	56	18	63	-	60	2	810.342.1	43,2
Pg 48	2"	47,8	66	20	77	-	74	2	810.348.1	74,8

\* Fittings for 5/16" conduit without UL/CSA approval.

## ANACONDA FITTINGS

## LIQUID-TIGHT FITTINGS FOR SEALTITE IP 67



## ANACONDA FITTINGS

## LIQUID-TIGHT FITTINGS FOR SEALTITE IP 67

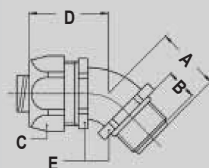

### Pg 45° fitting, male, nickel plated brass.



Thread	Sealtite	Min. Internal	Dimensions in mm					Standard	Article	Weight
Pg	Size (inch)	Bore (mm)	A	B	C	D	E	Package	Number	(Kg/100)
Pg 11	5/16"	8,3	23	12	26	33	22	10	810.412.1*	8,1
Pg 13,5	5/16"	8,3	23	12	26	33	22	10	810.414.1*	8,1
Pg 11	3/8"	10,2	23	12	26	33	22	10	810.411.1	8,1
Pg 13,5	3/8"	10,2	23	12	26	33	22	10	810.413.1	8,1
Pg 16	1/2"	13,9	25	13	29	33	27	10	810.416.1	11,6
Pg 21	3/4"	18,5	30	15	35	36	33	5	810.421.1	15,3
Pg 29	1"	23,8	34	15	45	46	42	5	810.429.1	31,5
Pg 36	1.1/4"	31,8	39	16	54	54	51	2	810.436.1	53,2
Pg 42	1.1/2"	36,8	45	18	63	59	60	2	810.442.1	78,5
Pg 48	2"	47,8	53	20	77	71	74	2	810.448.1	132,0

\* Fittings for 5/16" conduit without UL/CSA approval.



### Pg 90° fitting, male, nickel plated brass.

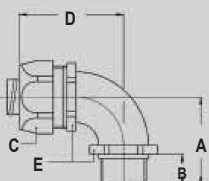

Thread	Sealtite	Min. Internal	Dimensions in mm					Standard	Article	Weight
Pg	Size (inch)	Bore (mm)	A	B	C	D	E	Package	Number	(Kg/100)
Pg 11	5/16"	8,3	32	12	26	42	22	10	810.912.1*	8,9
Pg 13,5	5/16"	8,3	32	12	26	42	22	10	810.914.1*	8,9
Pg 11	3/8"	10,2	32	12	26	42	22	10	810.911.1	8,9
Pg 13,5	3/8"	10,2	32	12	26	42	22	10	810.913.1	8,9
Pg 16	1/2"	13,9	36	13	29	43	27	10	810.916.1	15,3
Pg 21	3/4"	18,5	43	15	35	48	33	5	810.921.1	21,6
Pg 29	1"	23,8	48	15	45	59	42	5	810.929.1	35,3
Pg 36	1.1/4"	31,8	57	16	54	68	51	2	810.936.1	62,5
Pg 42	1.1/2"	36,8	63	18	63	78	60	2	810.942.1	88,1
Pg 48	2"	47,8	74	20	77	96	74	2	810.948.1	141,9

\* Fittings for 5/16" conduit without UL/CSA approval.



### Pg cable-hose fitting, male, nickel plated brass.

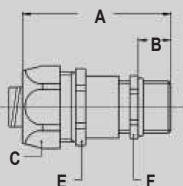

Thread	Sealtite	Clamping	Dimensions in mm					Standard	Article	Weight
Pg	Size (inch)	Range (mm)	A	B	C	E	F	Package	Number	(Kg/100)
Pg 9	5/16"	4 - 8	55	10	26	24	17	10	810.709.1	7,8
Pg 9	3/8"	5 - 8	55	10	26	24	20	10	810.712.1	7,8
Pg 11	3/8"	5 - 10	55	10	26	24	20	10	810.711.1	9,5
Pg 13,5	1/2"	6 - 12	57	10	29	27	22	10	810.715.1	9,7
Pg 16	1/2"	10 - 13,9	60	10	29	27	24	10	810.716.1	11,7
Pg 21	3/4"	13 - 18	67	12	35	33	30	5	810.721.1	19,6
Pg 29	1"	18 - 23,8	80	12	45	43	40	5	810.729.1	35,4



### Pg, EMC cable-hose fitting, male, nickel plated brass.

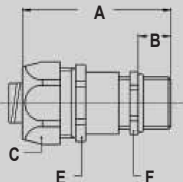

Thread	Sealtite	Clamping	Dimensions in mm					Standard	Article	Weight
Pg	Size (inch)	Range (mm)	A	B	C	E	F	Package	Number	(Kg/100)
Pg 9	5/16"	4 - 8	55	10	26	24	17	10	810.609.1	7,8
Pg 9	3/8"	5 - 8	55	10	26	24	20	10	810.612.1	7,8
Pg 11	3/8"	5 - 10	55	10	26	24	20	10	810.611.1	9,5
Pg 13,5	1/2"	6 - 12	57	10	29	27	22	10	810.615.1	9,7
Pg 16	1/2"	10 - 13,9	60	10	29	27	24	10	810.616.1	11,7
Pg 21	3/4"	13 - 18	67	12	35	33	30	5	810.621.1	19,6
Pg 29	1"	18 - 23,8	80	12	45	43	40	5	810.629.1	35,4



### NPT straight fitting, male, nickel plated brass.

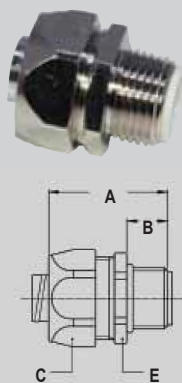

Thread	Sealtite	Min. Internal	Dimensions in mm					Standard	Article	Weight
NPT	Size (inch)	Bore (mm)	A	B	C	D	E	Package	Number	(Kg/100)
1/2" NPT	5/16"	8,3	35	12	26	-	24	10	814.011.1*	5,6
1/2" NPT	3/8"	10,2	35	12	26	-	24	10	814.012.1	5,6
1/2" NPT	1/2"	13,9	37	13	29	-	27	10	814.016.1	6,2
3/4" NPT	3/4"	18,5	40	15	35	-	33	5	814.020.1	8,9
1" NPT	1"	23,8	46	15	45	-	43	5	814.026.1	25,0
1.1/4" NPT	1.1/4"	31,8	52	16	54	-	52	2	814.035.1	40,0
1.1/2" NPT	1.1/2"	36,8	56	18	63	-	60	2	814.040.1	43,8
2" NPT	2"	47,8	66	20	77	-	74	2	814.050.1	73,5

\* Fittings for 1/4" and 5/16" conduit without UL/CSA approval.



### NPT 45° fitting, male, nickel plated brass.

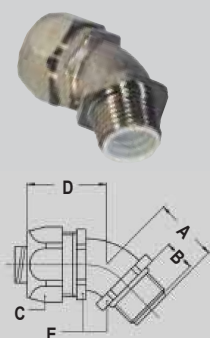

Thread	Sealtite	Min. Internal	Dimensions in mm					Standard	Article	Weight
NPT	Size (inch)	Bore (mm)	A	B	C	D	E	Package	Number	(Kg/100)
1/2" NPT	5/16"	8,3	23	12	26	33	22	10	814.411.1*	7,9
1/2" NPT	3/8"	10,2	23	12	26	33	22	10	814.412.1	7,9
1/2" NPT	1/2"	13,9	25	13	29	33	27	10	814.416.1	10,7
3/4" NPT	3/4"	18,5	30	15	35	36	33	5	814.420.1	15,7
1" NPT	1"	23,8	34	15	45	46	42	5	814.426.1	31,8
1.1/4" NPT	1.1/4"	31,8	39	16	54	54	51	2	814.435.1	54,2
1.1/2" NPT	1.1/2"	36,8	45	18	63	59	60	2	814.440.1	78,5
2" NPT	2"	47,8	53	20	77	71	74	2	814.450.1	132,0

\* Fittings for 5/16" conduit without UL/CSA approval.



### NPT 90° fitting, male, nickel plated brass.

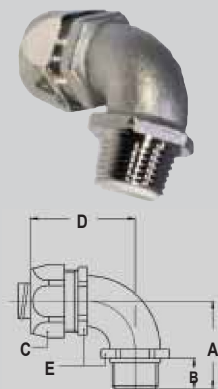

Thread	Sealtite	Min. Internal	Dimensions in mm					Standard	Article	Weight
NPT	Size (inch)	Bore (mm)	A	B	C	D	E	Package	Number	(Kg/100)
1/2" NPT	5/16"	8,3	32	12	26	42	22	10	814.911.1*	13,3
1/2" NPT	3/8"	10,2	32	12	26	42	22	10	814.912.1	13,3
1/2" NPT	1/2"	13,9	36	13	29	43	27	10	814.916.1	14,6
3/4" NPT	3/4"	18,5	43	15	35	48	33	5	814.920.1	22,0
1" NPT	1"	23,8	48	15	45	59	42	5	814.926.1	31,7
1.1/4" NPT	1.1/4"	31,8	57	16	54	68	51	2	814.935.1	62,5
1.1/2" NPT	1.1/2"	36,8	63	18	63	78	60	2	814.940.1	89,1
2" NPT	2"	47,8	74	20	77	96	74	2	814.950.1	141,9

\* Fittings for 5/16" conduit without UL/CSA approval.



### NPT cable-hose fitting, male, nickel plated brass.

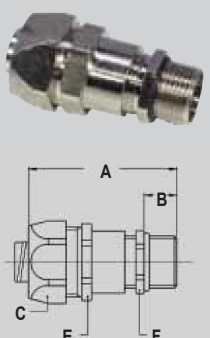

Thread	Sealtite	Clamping	Dimensions in mm					Standard	Article	Weight
NPT	Size (inch)	Range (mm)	A	B	C	E	F	Package	Number	(Kg/100)
3/8" NPT	5/16"	4 - 8	60	15	26	24	17	10	814.709.1	7,8
3/8" NPT	3/8"	4 - 8	60	15	26	24	17	10	814.710.1	7,8
1/2" NPT	3/8"	6 - 10,2	57	13	26	24	22	10	814.712.1	11,7
1/2" NPT	1/2"	6 - 12	59	13	29	27	22	10	814.715.1	11,7
3/4" NPT	3/4"	13 - 18	68	13	35	33	30	5	814.721.1	19,6

## NPT straight fitting, female, nickel plated brass.

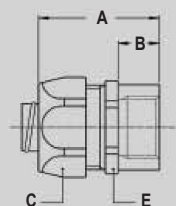

Thread	Sealtite	Min. Internal	Dimensions in mm					Standard	Article	Weight
NPT	Size (inch)	Bore (mm)	A	B	C	D	E	Package	Number	(Kg/100)
1/2" NPT	5/16"	8,3	37	13	26	-	24	10	814.311.1*	5,3
1/2" NPT	3/8"	10,2	37	13	26	-	24	10	814.312.1	5,3
1/2" NPT	1/2"	13,9	37	13	29	-	27	10	814.316.1	6,2
3/4" NPT	3/4"	18,5	40	15	35	-	33	5	814.320.1	9,0
1" NPT	1"	23,8	46	15	45	-	43	5	814.326.1	20,7
1.1/4" NPT	1.1/4"	31,8	52	16	54	-	52	2	814.335.1	29,3
1.1/2" NPT	1.1/2"	36,8	56	18	63	-	60	2	814.340.1	43,8
2" NPT	2"	47,8	66	20	77	-	74	2	814.350.1	73,3

\* Fittings for 5/16" conduit without UL/CSA approval.

## Grounding ferrule, nickel plated brass.



Thread	Sealtite	Min. Internal	Dimensions in mm					Standard	Article	Weight
	Size (inch)	Bore (mm)	A	B	C	D	E	Package	Number	(Kg/100)
-	1/4"	5,2	-	-	-	-	-	10	815.006.0	0,4
-	5/16"	8,3	-	-	-	-	-	10	815.010.0	0,8
-	3/8"	10,2	-	-	-	-	-	10	815.011.3	0,6
-	1/2"	13,9	-	-	-	-	-	10	815.016.3	0,8
-	3/4"	18,5	-	-	-	-	-	5	815.021.3	1,4
-	1"	23,8	-	-	-	-	-	5	815.029.3	2,8
-	1.1/4"	31,8	-	-	-	-	-	2	815.036.3	6,0
-	1.1/2"	36,8	-	-	-	-	-	2	815.042.3	6,8
-	2"	47,8	-	-	-	-	-	2	815.048.3	8,8

## Grounding ferrule, zinc plated steel.



Thread	Sealtite	Min. Internal	Dimensions in mm					Standard	Article	Weight
	Size (inch)	Bore (mm)	A	B	C	D	E	Package	Number	(Kg/100)
-	3/8"	10,2	-	-	-	-	-	10	815.011.0	0,4
-	1/2"	13,9	-	-	-	-	-	10	815.016.0	0,6
-	3/4"	18,5	-	-	-	-	-	5	815.021.0	0,8
-	1"	23,8	-	-	-	-	-	5	815.029.0	1,4

## Neoprene Sealing gasket for ISO



Thread	Thread	Thread	Dimensions in mm					Standard	Article	Weight
ISO	Pg	NPT	A	B	C	D	E	Package	Number	(Kg/100)
M16 x 1,5	-	-	1,2	-	20	14	-	100	815.416.0	0,03
M20 x 1,5	-	-	1,2	-	24	18	-	100	815.420.0	0,03
M25 x 1,5	-	-	1,2	-	30	23	-	50	815.425.0	0,05
M32 x 1,5	-	-	1,2	-	40	30	-	50	815.432.0	0,11
M40 x 1,5	-	-	1,2	-	48	38	-	50	815.440.0	0,15
M50 x 1,5	-	-	1,2	-	58	48	-	50	815.450.0	0,19
M63 x 1,5	-	-	1,2	-	75	61	-	50	815.463.0	0,33

ANACONDA  
FITTINGS

ACCESSORIES



## Anaconda compact fittings, UL & CSA, stainless steel AISI-304, for Anaconda Sealrite.

The compact version stainless steel Anaconda fittings can be used with all types of Anaconda Sealrite (except CNP). This Anaconda fitting is a universal fitting with shorter design and lower weight. All ferrules are flanged versions for a better fit. Because the fitting and ferrule are made from Stainless steel AISI-304 they offer an excellent corrosion protection in combination with a nice appearance. The compact fittings have UL & CSA approval.

**Construction:** Stainless steel AISI-304, consisting of 4 parts (counter nut, clamping ring, ferrule and body).

**Material:** Counter nut, body and ferrule are stainless steel



AISI-304. Clamping ring is made from PA6. The O-rings are from NBR rubber (black for ISO and blue for Pg).

**Special approvals:** UL-514B and CSA C 22.2 (combined UL/CSA file # E 234207).

Suitable for use in hazardous environments according NEC:

- Article 501.10 (B) (2) Class I, Division 2
- Article 502.10 (A) (2) and (B) (2) Class II, Division 1 and 2
- Article 503.10 (A) (3) and (B) Class III, Division 1 and 2

**Temperature:** -45 °C till +105 °C continuous

**Protection class:** IP 67 (dust-proof, water-tight)

**Colour:** Metal

### ISO straight fitting, compact, stainless steel AISI-304

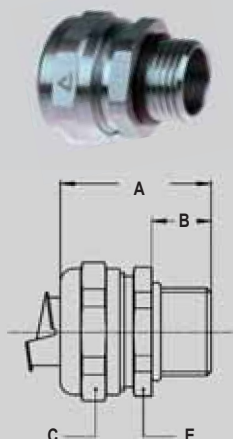

Thread	Sealrite	Min. Internal	Dimensions in mm					Standard	Article	Weight
ISO	Size (inch)	Bore (mm)	A	B	C	D	E	Package	Number	(Kg/100)
M16 x 1,5	3/8"	11,0	31	10	26	-	24	10	712.016.9	3,9
M20 x 1,5	3/8"	11,0	31	10	26	-	24	10	712.017.9	4,0
M20 x 1,5	1/2"	14,5	32	10	29	-	27	10	712.020.9	4,4
M25 x 1,5	3/4"	19,4	33	10	35	-	33	5	712.025.9	6,6
M32 x 1,5	1"	24,7	36	12	45	-	42	5	712.032.9	11,7
M40 x 1,5	1.1/4"	33,3	40	13	53	-	50	2	712.040.9	16,0
M50 x 1,5	1.1/2"	38,0	46	14	62	-	58	2	712.050.9	25,3
M63 x 1,5	2"	49,0	52	16	76	-	72	2	712.063.9	38,6

### ISO 90° fitting, compact, male, stainless steel AISI-304

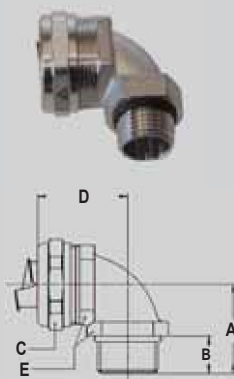

Thread	Sealrite	Min. Internal	Dimensions in mm					Standard	Article	Weight
ISO	Size (inch)	Bore (mm)	A	B	C	D	E	Package	Number	(Kg/100)
M16 x 1,5	3/8"	11,0	26	10	26	31	22	10	712.916.9	6,6
M20 x 1,5	3/8"	11,0	26	10	26	32	24	10	712.917.9	7,9
M20 x 1,5	1/2"	14,5	28	10	29	34	27	10	712.920.9	9,2
M25 x 1,5	3/4"	19,4	32	10	35	40	33	5	712.925.9	16,2
M32 x 1,5	1"	24,7	40	12	45	49	42	5	712.932.9	27,8
M40 x 1,5	1.1/4"	33,3	46	13	53	53	52	2	712.940.9	40,1
M50 x 1,5	1.1/2"	38,0	52	14	62	57	60	2	712.950.9	57,5
M63 x 1,5	2"	49,0	62	16	76	68	72	2	712.963.9	90,6



**NPT straight fitting, compact, male,  
stainless steel AISI-304**

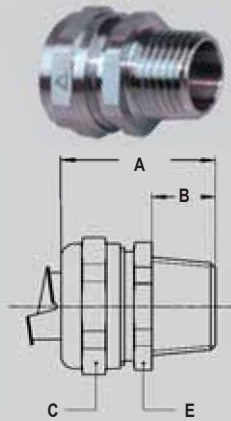

Thread	Sealtite	Min. Internal	Dimensions in mm					Standard	Article	Weight
NPT	Size (inch)	Bore (mm)	A	B	C	D	E	Package	Number	(Kg/100)
NPT 1/2"	3/8"	11,0	35	14	26	-	24	10	714.012.9	4,4
NPT 1/2"	1/2"	14,5	36	14	29	-	27	10	714.016.9	5,0
NPT 3/4"	3/4"	19,4	37	14	35	-	33	5	714.020.9	7,0
NPT 1"	1"	24,7	40	16	45	-	42	5	714.026.9	12,6
NPT 1.1/4"	1.1/4"	33,3	43	16	53	-	50	2	714.035.9	16,8
NPT 1.1/2"	1.1/2"	38,0	50	18	62	-	58	2	714.040.9	25,8
NPT 2"	2"	49,0	56	20	76	-	72	2	714.050.9	41,2

**NPT 90° fitting, compact, male, stainless  
steel AISI-304.**

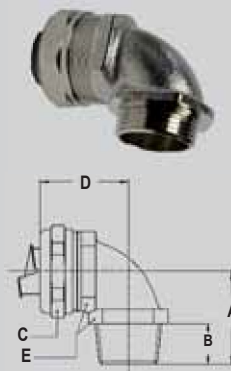

Thread	Sealtite	Min. Internal	Dimensions in mm					Standard	Article	Weight
NPT	Size (inch)	Bore (mm)	A	B	C	D	E	Package	Number	(Kg/100)
NPT 1/2"	3/8"	11,0	30	14	26	32	24	10	714.912.9	8,2
NPT 1/2"	1/2"	14,5	32	14	29	34	27	10	714.916.9	9,6
NPT 3/4"	3/4"	19,4	36	14	35	40	33	5	714.920.9	16,7
NPT 1"	1"	24,7	44	16	45	49	42	5	714.926.9	28,3
NPT 1.1/4"	1.1/4"	33,3	49	16	53	53	52	2	714.935.9	41,4
NPT 1.1/2"	1.1/2"	38,0	56	18	62	57	60	2	714.940.9	57,3
NPT 2"	2"	49,0	66	20	76	68	72	2	714.950.9	90,8

**NPT straight fitting, compact, male, stainless  
steel AISI-304, including washer and locknut**

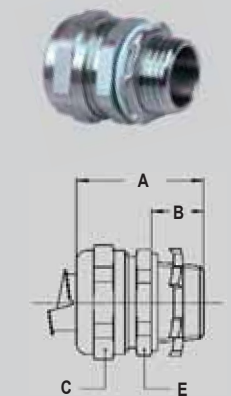

Thread	Sealtite	Min. Internal	Dimensions in mm					Standard	Article	Weight
NPT	Size (inch)	Bore (mm)	A	B	C	D	E	Package	Number	(Kg/100)
NPT 1/2"	3/8"	11,0	35	14	26	-	24	10	714.012.92	4,9
NPT 1/2"	1/2"	14,5	36	14	29	-	27	10	714.016.92	5,5
NPT 3/4"	3/4"	19,4	37	14	35	-	33	5	714.020.92	7,8
NPT 1"	1"	24,7	40	16	45	-	42	5	714.026.92	13,9
NPT 1.1/4"	1.1/4"	33,3	43	16	53	-	50	2	714.035.92	18,6
NPT 1.1/2"	1.1/2"	38,0	50	18	62	-	58	2	714.040.92	28,0
NPT 2"	2"	49,0	56	20	76	-	72	2	714.050.92	44,0

**NPT 90° fitting, compact, male, stainless  
steel AISI-304, including washer and locknut**

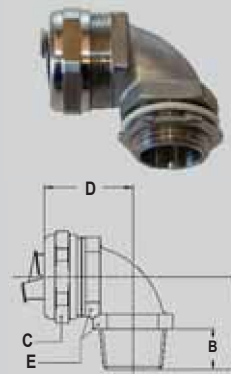

Thread	Sealtite	Min. Internal	Dimensions in mm					Standard	Article	Weight
NPT	Size (inch)	Bore (mm)	A	B	C	D	E	Package	Number	(Kg/100)
NPT 1/2"	3/8"	11,0	30	14	26	32	24	10	714.912.92	8,7
NPT 1/2"	1/2"	14,5	32	14	29	34	27	10	714.916.92	10,1
NPT 3/4"	3/4"	19,4	36	14	35	40	33	5	714.920.92	16,6
NPT 1"	1"	24,7	44	16	45	49	42	5	714.926.92	29,6
NPT 1.1/4"	1.1/4"	33,3	49	16	53	53	52	2	714.935.92	43,2
NPT 1.1/2"	1.1/2"	38,0	56	18	62	57	60	2	714.940.92	59,5
NPT 2"	2"	49,0	66	20	76	68	72	2	714.950.92	93,6

**ANACONDA  
COMPACT  
FITTINGS**

**LIQUID-TIGHT  
FITTINGS FOR  
SEALTITE  
IP 67**

### Grounding ferrule, stainless steel AISI-304



Thread	Sealtite	Min. Internal	Dimensions in mm					Standard	Article	Weight
	Size (inch)	Bore (mm)	A	B	C	D	E	Package	Number	(Kg/100)
-	3/8"	11,0	-	-	-	-	-	50	815.011.5	0,4
-	1/2"	14,5	-	-	-	-	-	50	815.016.5	0,5
-	3/4"	19,4	-	-	-	-	-	25	815.021.5	0,7
-	1"	24,7	-	-	-	-	-	25	815.029.5	1,1
-	1.1/4"	33,3	-	-	-	-	-	10	815.036.5	1,5
-	1.1/2"	38,0	-	-	-	-	-	10	815.042.5	2,1
-	2"	49,0	-	-	-	-	-	10	815.048.5	3,2

### Lock nuts, stainless steel (AISI-304), ISO.



Thread	Sealtite	Min. Internal	Dimensions in mm					Standard	Article	Weight
ISO	Size (inch)	Bore (mm)	A	B	C	D	E	Package	Number	(Kg/100)
M16 x 1,5	-	-	2,8	-	19	-	-	50	880.116.9	0,5
M20 x 1,5	-	-	3,5	-	24	-	-	50	880.120.9	0,7
M25 x 1,5	-	-	3,5	-	30	-	-	25	880.125.9	1,1
M32 x 1,5	-	-	4,5	-	35	-	-	25	880.132.9	2,4
M40 x 1,5	-	-	4,5	-	45	-	-	5	880.140.9	3,6
M50 x 1,5	-	-	5,5	-	55	-	-	5	880.150.9	5,4
M63 x 1,5	-	-	6,0	-	70	-	-	5	880.163.9	6,2

### NPT locknut, stainless steel AISI-304



Thread	Sealtite	Min. Internal	Dimensions in mm					Standard	Article	Weight
	Size (inch)	Bore (mm)	A	B	C	D	E	Package	Number	(Kg/100)
NPT 1/2"	1/2"	-	-	-	-	-	-	100	880.316.9	0,5
NPT 3/4"	3/4"	-	-	-	-	-	-	50	880.320.9	0,8
NPT 1"	1"	-	-	-	-	-	-	50	880.326.9	1,3
NPT 1.1/4"	1.1/4"	-	-	-	-	-	-	20	880.335.9	1,8
NPT 1.1/2"	1.1/2"	-	-	-	-	-	-	20	880.340.9	2,2
NPT 2"	2"	-	-	-	-	-	-	20	880.350.9	2,8

### NPT flat seal, NBR Rubber



Thread	Sealtite	Min. Internal	Dimensions in mm					Standard	Article	Weight
	Size (inch)	Bore (mm)	A	B	C	D	E	Package	Number	(Kg/100)
NPT 1/2"	1/2"	-	-	-	-	-	-	50	815.616.0	0,03
NPT 3/4"	3/4"	-	-	-	-	-	-	25	815.620.0	0,05
NPT 1"	1"	-	-	-	-	-	-	25	815.626.0	0,11
NPT 1.1/4"	1.1/4"	-	-	-	-	-	-	10	815.635.0	0,15
NPT 1.1/2"	1.1/2"	-	-	-	-	-	-	10	815.640.0	0,19
NPT 2"	2"	-	-	-	-	-	-	10	815.650.0	0,33

## ANACONDA COMPACT FITTINGS

## LIQUID-TIGHT FITTINGS FOR SEALTITE IP 67



### Anaconda stainless steel fittings for Anaconda Sealtite.

The stainless steel Anaconda fittings can be used with all types of Anaconda Sealtite (except CNP). These fittings are available in AISI-304 and AISI-316 and offer superior corrosion resistance. These stainless steel Anaconda fittings are mostly used in the off-shore, chemical and food industry. Because of the UL & CSA approvals the fittings are also suitable for export projects outside Europe.

#### Material & Construction:

**Construction:** Stainless steel (AISI-304) fitting, consisting of 4 parts (counter nut, clamping ring, ferrule and body).

**Material:** Counter nut and body are stainless steel (AISI-304) and the ferrule is from nickel plated brass. Clamping



ring and insert are from PA6 (red for ISO metric, blue for Pg and white for NPT).

**Special approvals:** UL-514B and CSA C 22.2 (combined UL/CSA file # E 234207).

Suitable for use in hazardous environments according NEC:

- Article 501.10 (B) (2) Class I, Division 2
- Article 502.10 (A) (2) and (B) (2) Class II, Division 1 and 2
- Article 503.10 (A) (3) and (B) Class III, Division 1 and 2

**Temperature:** -45 °C till +105 °C continuous (cable-hose-fittings are -40 °C till +100 °C).

**Protection class:** IP 67 (dust-proof, water-tight), with cable-hose fittings an IP 68 rate on the switchbox can be obtained.

**Colour:** Metal.

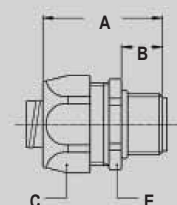

#### ISO straight fitting, male, stainless steel (AISI-304).



Thread	Sealtite	Min. Internal	Dimensions in mm					Standard	Article	Weight
ISO	Size (inch)	Bore (mm)	A	B	C	D	E	Package	Number	(Kg/100)
M16 x 1,5	5/16"	8,3	35	12	27	-	24	10	812.015.9*	4,8
M20 x 1,5	5/16"	8,3	36	13	27	-	24	10	812.014.9*	5,1
M16 x 1,5	3/8"	10,2	35	12	27	-	24	10	812.016.9	4,8
M20 x 1,5	3/8"	10,2	36	13	27	-	24	10	812.017.9	5,1
M20 x 1,5	1/2"	13,9	37	13	30	-	27	10	812.020.9	5,9
M25 x 1,5	3/4"	18,5	40	15	36	-	36	5	812.025.9	7,9
M32 x 1,5	1"	23,8	46	15	46	-	46	5	812.032.9	17,5
M40 x 1,5	1.1/4"	31,8	52	16	54	-	52	2	812.040.9	27,9

\* Fittings for 5/16" conduit without UL/CSA approval

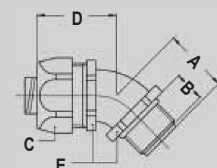

#### ISO 45° fitting, male, stainless steel (AISI-304).



Thread	Sealtite	Min. Internal	Dimensions in mm					Standard	Article	Weight
ISO	Size (inch)	Bore (mm)	A	B	C	D	E	Package	Number	(Kg/100)
M16 x 1,5	5/16"	8,3	23	12	27	33	22	10	812.415.9*	7,3
M20 x 1,5	5/16"	8,3	24	13	27	33	22	10	812.414.9*	7,4
M16 x 1,5	3/8"	10,2	23	12	27	33	22	10	812.416.9	7,3
M20 x 1,5	3/8"	10,2	24	13	27	33	22	10	812.417.9	7,4
M20 x 1,5	1/2"	13,9	25	13	30	33	27	10	812.420.9	10,5
M25 x 1,5	3/4"	18,5	30	15	36	36	33	5	812.425.9	13,6

\* Fittings for 5/16" conduit without UL/CSA approval.

**ISO 90° fitting, male, stainless steel  
(AISI-304).**

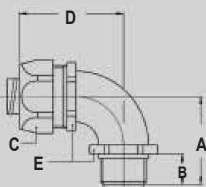

Thread	Sealtite	Min. Internal	Dimensions in mm					Standard	Article	Weight
ISO	Size (inch)	Bore (mm)	A	B	C	D	E	Package	Number	(Kg/100)
M16 x 1,5	5/16"	8,3	32	12	27	42	22	10	812.915.9*	8,2
M20 x 1,5	5/16"	8,3	33	13	27	42	22	10	812.914.9*	8,4
M16 x 1,5	3/8"	10,2	32	12	27	42	22	10	812.916.9	8,2
M20 x 1,5	3/8"	10,2	33	13	27	42	22	10	812.917.9	8,4
M20 x 1,5	1/2"	13,9	36	13	30	43	27	10	812.920.9	12,6
M25 x 1,5	3/4"	18,5	43	15	36	48	33	5	812.925.9	19,2

\* Fittings for 5/16" conduit without UL/CSA approval,.

**ISO cable-hose fitting, male, stainless steel  
(AISI-304).**

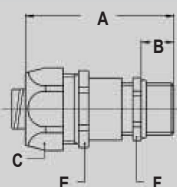

Thread	Sealtite	Clamping	Dimensions in mm					Standard	Article	Weight
ISO	Size (inch)	Range (mm)	A	B	C	E	F	Package	Number	(Kg/100)
M16 x 1,5	5/16"	4 - 8	57	12	27	24	18	10	812.715.9*	7,8
M16 x 1,5	3/8"	4 - 8	57	12	27	24	18	10	812.716.9	7,8
M20 x 1,5	3/8"	6 - 10,2	57	12	27	24	22	10	812.717.9	9,5
M20 x 1,5	1/2"	6 - 12	59	12	30	27	22	10	812.720.9	9,7

\* Fittings for 5/16" conduit,.

**Pg straight fitting, male, stainless steel  
(AISI-304).**

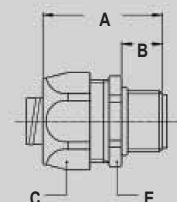

Thread	Sealtite	Min. Internal	Dimensions in mm					Standard	Article	Weight
Pg	Size (inch)	Bore (mm)	A	B	C	D	E	Package	Number	(Kg/100)
Pg 11	5/16"	8,3	35	12	27	-	24	10	810.012.9*	5,6
Pg 13,5	5/16"	8,3	35	12	27	-	24	10	810.014.9*	5,6
Pg 11	3/8"	10,2	35	12	27	-	24	10	810.011.9	5,6
Pg 13,5	3/8"	10,2	35	12	27	-	24	10	810.013.9	5,6
Pg 16	1/2"	13,9	37	13	30	-	27	10	810.016.9	6,3
Pg 21	3/4"	18,5	40	15	36	-	36	5	810.021.9	8,4
Pg 29	1"	23,8	46	15	46	-	46	5	810.029.9	25,0
Pg 36	1.1/4"	31,8	52	16	54	-	52	2	810.036.9	34,6
Pg 42	1.1/2"	36,8	56	18	63	-	60	2	810.042.9	47,2
Pg 48	2"	47,8	66	20	77	-	74	2	810.048.9	72,0

\* Fittings for 5/16" conduit without UL/CSA approval,.

**Pg 90° fitting, male, stainless steel  
(AISI-304).**

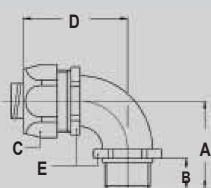

Thread	Sealtite	Min. Internal	Dimensions in mm					Standard	Article	Weight
Pg	Size (inch)	Bore (mm)	A	B	C	D	E	Package	Number	(Kg/100)
Pg 11	5/16"	8,3	32	12	27	42	22	10	810.912.9*	8,9
Pg 11	3/8"	10,2	32	12	27	42	22	10	810.911.9	8,9
Pg 16	1/2"	13,9	36	13	30	43	27	10	810.916.9	15,3
Pg 21	3/4"	18,5	43	15	36	48	33	5	810.921.9	21,6
Pg 29	1"	23,8	48	15	46	50	42	5	810.929.9	35,3

\* Fittings for 5/16" conduit without UL/CSA approval,.

**ANACONDA  
SEALTITE®  
SPECIAL**

**LIQUID-TIGHT  
FITTINGS FOR  
SEALTITE  
IP 67**



## NPT straight fitting, male, stainless steel (AISI-304).

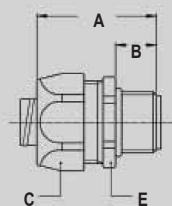

Thread	Sealtite Size (inch)	Min. Internal Bore (mm)	Dimensions in mm					Standard Package	Article Number	Weight (Kg/100)
			A	B	C	D	E			
1/2" NPT	5/16"	8,3	37	13	27	-	24	10	814.011.9*	5,6
1/2" NPT	3/8"	10,2	37	13	27	-	24	10	814.012.9	5,6
1/2" NPT	1/2"	13,9	37	13	30	-	27	10	814.016.9	6,2
3/4" NPT	3/4"	18,5	40	15	36	-	36	5	814.020.9	8,9
1" NPT	1"	23,8	46	15	46	-	46	5	814.026.9	25,0

\* Fittings for 5/16" conduit without UL/CSA approval.

## NPT 45° fitting, male, stainless steel (AISI-304).

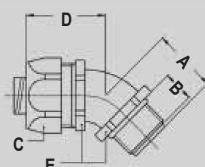

Thread	Sealtite Size (inch)	Min. Internal Bore (mm)	Dimensions in mm					Standard Package	Article Number	Weight (Kg/100)
			A	B	C	D	E			
1/2" NPT	5/16"	8,3	25	13	27	33	22	10	814.411.9*	7,9
1/2" NPT	3/8"	10,2	25	13	27	33	22	10	814.412.9	7,9
1/2" NPT	1/2"	13,9	25	13	30	33	27	10	814.416.9	10,7
3/4" NPT	3/4"	18,5	30	15	36	36	33	5	814.420.9	15,7

\* Fittings for 5/16" conduit without UL/CSA approval.

## NPT 90° fitting, male, stainless steel (AISI-304).

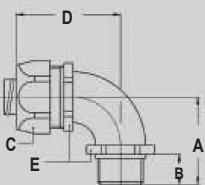

Thread	Sealtite Size (inch)	Min. Internal Bore (mm)	Dimensions in mm					Standard Package	Article Number	Weight (Kg/100)
			A	B	C	D	E			
1/2" NPT	5/16"	8,3	36	13	27	43	22	10	814.911.9*	13,3
1/2" NPT	3/8"	10,2	36	13	27	43	22	10	814.912.9	13,3
1/2" NPT	1/2"	13,9	36	13	30	43	27	10	814.916.9	14,6
3/4" NPT	3/4"	18,5	43	15	36	48	33	5	814.920.9	22,0
1" NPT	1"	23,8	48	15	46	59	42	5	814.926.9	31,7

\* Fittings for 5/16" conduit without UL/CSA approval.

## Grounding ferrule, nickel plated brass.



Thread	Sealtite Size (inch)	Min. Internal Bore (mm)	Dimensions in mm					Standard Package	Article Number	Weight (Kg/100)
			A	B	C	D	E			
-	5/16"	8,3	-	-	-	-	-	10	815.010.0	0,8
-	3/8"	10,2	-	-	-	-	-	10	815.011.3	0,6
-	1/2"	13,9	-	-	-	-	-	10	815.016.3	0,8
-	3/4"	18,5	-	-	-	-	-	5	815.021.3	1,4
-	1"	23,8	-	-	-	-	-	5	815.029.3	2,8
-	1.1/4"	31,8	-	-	-	-	-	2	815.036.3	6,0
-	1.1/2"	36,8	-	-	-	-	-	2	815.042.3	6,8
-	2"	47,8	-	-	-	-	-	2	815.048.3	8,8

ANACONDA  
SEALTITE®  
SPECIAL

LIQUID-TIGHT  
FITTINGS FOR  
SEALTITE  
IP 67



## Anaconda compact fittings, UL & CSA, stainless steel AISI-316, for Anaconda Sealite.

The compact version stainless steel Anaconda fittings can be used with all types of Anaconda Sealite (except CNP). This Anaconda fitting is a universal fitting with shorter design and lower weight. All ferrules are flanged versions for a better fit. Because the fitting and ferrule are made from Stainless steel AISI-316 they offer an excellent corrosion protection in combination with a nice appearance. The compact fittings have UL & CSA approval.

**Construction:** Stainless steel AISI-316, consisting of 4 parts (counter nut, clamping ring, ferrule and body).

**Material:** Counter nut, body are stainless steel AISI-316



and ferrule are stainless steel AISI-304. Clamping ring is made from PA6. The O-rings are from NBR rubber.

**Special approvals:** UL-514B and CSA C 22.2 (combined UL/CSA file # E 234207).

Suitable for use in hazardous environments according NEC:

- Article 501.10 (B) (2) Class I, Division 2

- Article 502.10 (A) (2) and (B) (2) Class II, Division 1 and 2

- Article 503.10 (A) (3) and (B) Class III, Division 1 and 2

**Temperature:** -45 °C till +105 °C continuous

**Protection class:** IP 67 (dust-proof, water-tight)

**Colour:** Metal

### ISO straight fitting, compact, stainless steel AISI-316

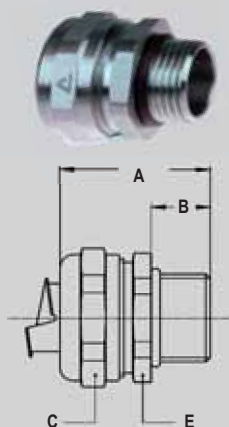

Thread	Sealite	Min. Internal	Dimensions in mm					Standard	Article	Weight
ISO	Size (inch)	Bore (mm)	A	B	C	D	E	Package	Number	(Kg/100)
M16 x 1,5	3/8"	11,0	31	10	26	-	24	10	712.116.9	3,9
M20 x 1,5	3/8"	11,0	31	10	26	-	24	10	712.117.9	4,0
M20 x 1,5	1/2"	14,5	32	10	29	-	27	10	712.120.9	4,4
M25 x 1,5	3/4"	19,4	33	10	35	-	33	5	712.125.9	6,6
M32 x 1,5	1"	24,7	36	12	45	-	42	5	712.132.9	11,7
M40 x 1,5	1.1/4"	33,3	40	13	53	-	50	2	712.140.9	16,0
M50 x 1,5	1.1/2"	38,0	46	14	62	-	58	2	712.150.9	25,3
M63 x 1,5	2"	49,0	52	16	76	-	72	2	712.163.9	38,6

### ISO 90° fitting, compact, male, stainless steel AISI-316

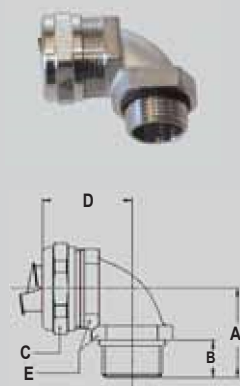

Thread	Sealite	Min. Internal	Dimensions in mm					Standard	Article	Weight
ISO	Size (inch)	Bore (mm)	A	B	C	D	E	Package	Number	(Kg/100)
M16 x 1,5	3/8"	11,0	26	10	26	31	22	10	712.516.9	6,6
M20 x 1,5	3/8"	11,0	26	10	26	32	24	10	712.517.9	7,9
M20 x 1,5	1/2"	14,5	28	10	29	34	27	10	712.520.9	9,2
M25 x 1,5	3/4"	19,4	32	10	35	40	33	5	712.525.9	16,2
M32 x 1,5	1"	24,7	40	12	45	49	42	5	712.532.9	27,8
M40 x 1,5	1.1/4"	33,3	46	13	53	53	52	2	712.540.9	40,1
M50 x 1,5	1.1/2"	38,0	52	14	62	57	60	2	712.550.9	57,5
M63 x 1,5	2"	49,0	62	16	76	68	72	2	712.563.9	90,6

**NPT straight fitting, compact, male,  
stainless steel AISI-316**

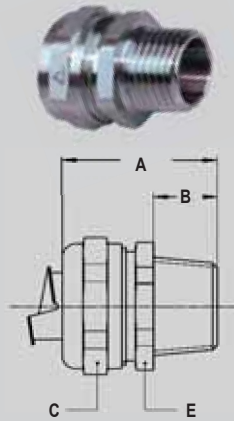

Thread	Sealtite	Min. Internal	Dimensions in mm					Standard	Article	Weight
NPT	Size (inch)	Bore (mm)	A	B	C	D	E	Package	Number	(Kg/100)
NPT 1/2"	3/8"	11,0	35	14	26	-	24	10	714.112.9	4,4
NPT 1/2"	1/2"	14,5	36	14	29	-	27	10	714.116.9	5,0
NPT 3/4"	3/4"	19,4	37	14	35	-	33	5	714.120.9	7,0
NPT 1"	1"	24,7	40	16	45	-	42	5	714.126.9	12,6
NPT 1.1/4"	1.1/4"	33,3	43	16	53	-	50	2	714.135.9	16,8
NPT 1.1/2"	1.1/2"	38,0	50	18	62	-	58	2	714.140.9	25,8
NPT 2"	2"	49,0	56	20	76	-	72	2	714.150.9	41,2

**NPT 90° fitting, compact, male, stainless  
steel AISI-316**

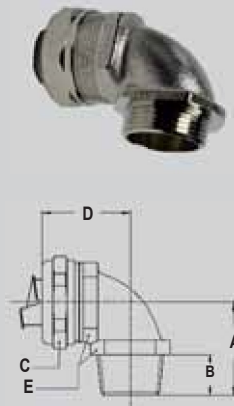

Thread	Sealtite	Min. Internal	Dimensions in mm					Standard	Article	Weight
NPT	Size (inch)	Bore (mm)	A	B	C	D	E	Package	Number	(Kg/100)
NPT 1/2"	3/8"	11,0	30	14	26	32	24	10	714.512.9	8,2
NPT 1/2"	1/2"	14,5	32	14	29	34	27	10	714.516.9	9,6
NPT 3/4"	3/4"	19,4	36	14	35	40	33	5	714.520.9	16,7
NPT 1"	1"	24,7	44	16	45	49	42	5	714.526.9	28,3
NPT 1.9/4"	1.1/4"	33,3	49	16	53	53	52	2	714.535.9	41,4
NPT 1.9/2"	1.1/2"	38,0	56	18	62	57	60	2	714.540.9	57,3
NPT 2"	2"	49,0	66	20	76	68	72	2	714.550.9	90,8

**NPT straight fitting, compact, male,  
stainless steel AISI-316 (incl. locknut)**

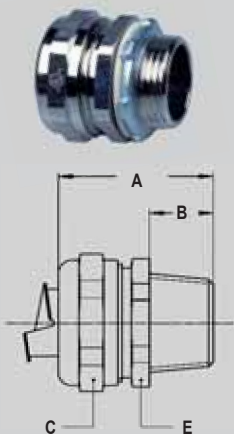

Thread	Sealtite	Min. Internal	Dimensions in mm					Standard	Article	Weight
NPT	Size (inch)	Bore (mm)	A	B	C	D	E	Package	Number	(Kg/100)
NPT 1/2"	3/8"	11,0	35	14	26	-	24	10	714.112.92	4,9
NPT 1/2"	1/2"	14,5	36	14	29	-	27	10	714.116.92	5,5
NPT 3/4"	3/4"	19,4	37	14	35	-	33	5	714.120.92	7,8
NPT 1"	1"	24,7	40	16	45	-	42	5	714.126.92	13,9
NPT 1.1/4"	1.1/4"	33,3	43	16	53	-	50	2	714.135.92	18,6
NPT 1.1/2"	1.1/2"	38,0	50	18	62	-	58	2	714.140.92	28,0
NPT 2"	2"	49,0	56	20	76	-	72	2	714.150.92	44,0

**ANACONDA  
SEALTITE®  
SPECIAL**

**LIQUID-TIGHT  
FITTINGS FOR  
SEALTITE  
IP 67**

**NPT 90° fitting, compact, male, stainless steel AISI-316 (incl. locknut)**



GOST-R

RoHS

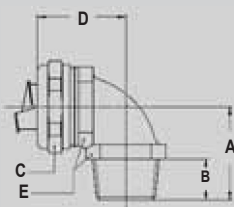

Thread	Sealtite	Min. Internal	Dimensions in mm					Standard	Article	Weight
NPT	Size (inch)	Bore (mm)	A	B	C	D	E	Package	Number	(Kg/100)
NPT 1/2"	3/8"	11,0	30	14	26	32	24	10	714.512.92	8,7
NPT 1/2"	1/2"	14,5	32	14	29	34	27	10	714.516.92	10,1
NPT 3/4"	3/4"	19,4	36	14	35	40	33	5	714.520.92	16,7
NPT 1"	1"	24,7	44	16	45	49	42	5	714.526.92	29,6
NPT 1.9/4"	1.1/4"	33,3	49	16	53	53	52	2	714.535.92	43,2
NPT 1.9/2"	1.1/2"	38,0	56	18	62	57	60	2	714.540.92	59,5
NPT 2"	2"	49,0	66	20	76	68	72	2	714.550.92	93,6



GOST-R

RoHS

**Grounding ferrule, stainless steel AISI-304**



Thread	Sealtite	Min. Internal	Dimensions in mm					Standard	Article	Weight
	Size (inch)	Bore (mm)	A	B	C	D	E	Package	Number	(Kg/100)
-	3/8"	11,0	-	-	-	-	-	50	815.011.5	0,4
-	1/2"	14,5	-	-	-	-	-	50	815.016.5	0,5
-	3/4"	19,4	-	-	-	-	-	25	815.021.5	0,7
-	1"	24,7	-	-	-	-	-	25	815.029.5	1,1
-	1.1/4"	33,3	-	-	-	-	-	10	815.036.5	1,5
-	1.1/2"	38,0	-	-	-	-	-	10	815.042.5	2,1
-	2"	49,0	-	-	-	-	-	10	815.048.5	3,2



GOST-R

RoHS

**Grounding ferrule, stainless steel AISI-316.**



Thread	Sealtite	Min. Internal	Dimensions in mm					Standard	Article	Weight
	Size (inch)	Bore (mm)	A	B	C	D	E	Package	Number	(Kg/100)
-	3/8"	10,2	-	-	-	-	-	10	815.011.9	0,6
-	1/2"	13,9	-	-	-	-	-	10	815.016.9	0,8
-	3/4"	18,5	-	-	-	-	-	5	815.021.9	1,4
-	1"	23,8	-	-	-	-	-	5	815.029.9	2,8

**ANACONDA  
SEALTITE®  
SPECIAL**

**LIQUID-TIGHT  
FITTINGS FOR  
SEALTITE  
IP 67**

## ANACONDA SEALTITE® SPECIAL

### LIQUID-TIGHT FITTINGS FOR SEALTITE IP 67



### Anaconda stainless steel AISI-316 fittings for Anaconda Sealtite.

The stainless steel AISI-316 Anaconda fittings can be used with all types of Anaconda Sealtite (except CNP) and offer the highest corrosion resistance. These stainless steel Anaconda fittings are mostly used in the off-shore, chemical and food industry. Because of the UL & CSA approvals the fittings are also suitable for export projects outside Europe.

#### **Material & Construction:**

**Construction:** Stainless steel (AISI-316) fitting, consisting of 4 parts (counter nut, clamping ring, ferrule and body).

**Material:** Counter nut and body are stainless steel (AISI-316) and the ferrule is from nickel plated brass. Clamping



ring and insert are from PA6 (red for ISO metric and white for NPT).

**Special approvals:** UL-514B and CSA C 22.2 (combined UL/CSA file # E 234207).

Suitable for use in hazardous environments according NEC:

- Article 501.10 (B) (2) Class I, Division 2
- Article 502.10 (A) (2) and (B) (2) Class II, Division 1 and 2
- Article 503.10 (A) (3) and (B) Class III, Division 1 and 2

**Temperature:** -45 °C till +105 °C continuous.

**Protection class:** IP 67 (dust-proof, water-tight).

**Colour:** Metal.

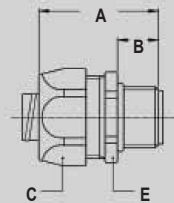

#### ISO straight fitting, male, stainless steel (AISI-316).



Thread	Sealtite Size (inch)	Min. Internal Bore (mm)	Dimensions in mm					Standard Package	Article Number	Weight (Kg/100)
			A	B	C	D	E			
M16 x 1,5	3/8"	10,2	35	12	26	-	24	10	812.116.9	4,8
M20 x 1,5	1/2"	13,9	37	13	29	-	27	10	812.120.9	5,9
M25 x 1,5	3/4"	18,5	40	15	35	-	33	5	812.125.9	7,9
M32 x 1,5	1"	23,8	46	15	45	-	43	5	812.132.9	17,5

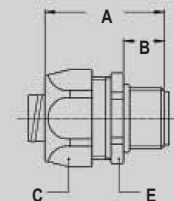

#### Pg straight fitting, male, stainless steel (AISI-316).



Thread	Sealtite Size (inch)	Min. Internal Bore (mm)	Dimensions in mm					Standard Package	Article Number	Weight (Kg/100)
			A	B	C	D	E			
Pg 16	1/2"	13,9	37	13	30	-	27	10	810.116.9	6,3
Pg 21	3/4"	18,5	40	15	36	-	36	5	810.121.9	8,4
Pg 29	1"	23,8	46	15	46	-	46	5	810.129.9	25,0

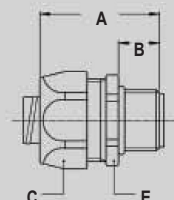

#### NPT straight fitting, male, stainless steel (AISI-316).



Thread	Sealtite Size (inch)	Min. Internal Bore (mm)	Dimensions in mm					Standard Package	Article Number	Weight (Kg/100)
			A	B	C	D	E			
1/2" NPT	3/8"	10,2	35	12	26	-	24	10	814.112.9	5,6
1/2" NPT	1/2"	13,9	37	13	29	-	27	10	814.116.9	6,2
3/4" NPT	3/4"	18,5	40	15	35	-	33	5	814.120.9	8,9
1" NPT	1"	23,8	46	15	45	-	43	5	814.126.9	25,0



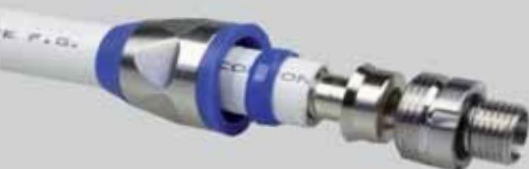

## Anaconda Hygienic Design, stainless steel AISI-316 “food fitting” for Anaconda Sealbite.

Anaconda hygienically designed, stainless steel food fittings can be used with all types of Anaconda Sealbite conduits (except CNP). These stainless fittings are designed with rounded corners and have a smooth contourless profile to minimise the risk of bacteria deposits and to promote easy cleaning. They display excellent resistance to corrosion.

### Material & Construction:

**Construction:** Stainless steel (AISI-316) fitting, consisting of 6 parts (lower seal, counter nut, upper seal, clamping ring, ferrule and body).

**Material:** Counter nut and body are stainless steel (AISI-316) and the ferrule is from nickel plated brass. Clamping



ring is from PA6. The blue rubber is made of TPE in accordance with FDA-CFR 21.

**Special approvals:** Special TPE seals, halogen-free, specially formulated for food and beverage applications per FDA guideline CFR 21.

**Temperature:** -45 °C till +105 °C continuous.

**Protection class:** IP 68 according EN 60529, IP69K according DIN 40050-9 (till 40 Bar high pressure).

**Colour:** Metal.

### ISO straight food grade fitting, male, stainless steel (AISI-316).

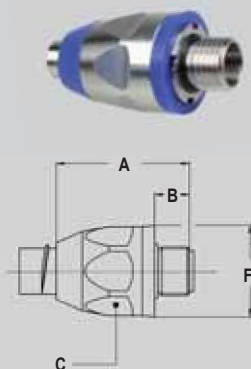

Thread	Sealtite	Min. Internal	Dimensions in mm						Standard	Article	Weight
ISO	Size (inch)	Bore (mm)	A	B	C	D	E	F	Package	Number	(Kg/100)
M16 x 1,5	3/8"	10,4	48	12	27	-	31		10	832.016.9	6,6
M20 x 1,5	1/2"	13,8	50	13	30	-	34		10	832.020.9	8,0
M25 x 1,5	3/4"	18,5	57	15	36	-	41		5	832.025.9	11,8
M32 x 1,5	1"	23,8	68	15	46	-	53		5	832.032.9	22,8
M40 x 1,5	1.1/4"	31,8	75	16	54	-	62		2	832.040.9	34,2
M50 x 1,5	1.1/2"	36,8	81	18	63	-	70		1	832.050.9	38,6
M63 x 1,5	2"	47,8	88	20	77	-	85		1	832.063.9	76,6

**ANACONDA  
SEALTITE®  
SPECIAL**

**LIQUID-TIGHT  
FITTINGS FOR  
SEALTITE  
IP 68**

## ANACONDA COMPACT FITTINGS

## LIQUID-TIGHT FITTINGS FOR SEALTITE IP 67



### Anaconda swivel fittings, stainless steel AISI-316 , for Anaconda Sealtite.

The swivel version stainless steel AISI-316 Anaconda fittings can be used with all types of Anaconda Sealtite (except CNP). This Anaconda fitting is a universal fitting with a special swivel mechanism for a higher tensile strength and a high water proof protection (IP67). All ferrules are turned nickel plated brass versions for a better fit. The high quality stainless steel AISI-316 offers a superb corrosion protection in combination with a nice appearance.



**Construction:** Stainless steel AISI-316 fitting, consisting of 4 parts (counter nut, clamping ring, ferrule and body).

**Material:** Counter nut and body are stainless steel AISI-316. Clamping ring is made from PA6 and the ferrule is made from nickel plated brass. The O-rings are from NBR rubber (black for ISO).

**Temperature:** -45 °C till +105 °C continuous

**Protection class:** IP 67

**Colour:** Metal

### NPT 45° swivel fitting, male, stainless steel (AISI-316).

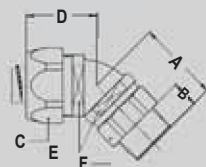

Thread	Sealtite	Min. Internal	Dimensions in mm						Standard	Article	Weight
NPT	Size (inch)	Bore (mm)	A	B	C	D	E	F	Package	Number	(Kg/100)
NPT 1/2"	3/8"	10,4	36	12	27	28	22	22	10	819.212.9	11,5
NPT 1/2"	1/2"	13,8	36	12	30	30	27	25	10	819.216.9	14,0
NPT 3/4"	3/4"	17,4	-	12	36	-	-	-	5	838.220.9	22,0
NPT 1"	1"	23,4	-	13	46	-	-	-	5	838.226.9	37,0

### NPT 90° swivel fitting, male, stainless steel (AISI-316).

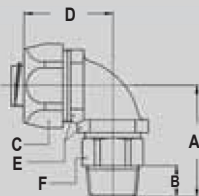

Thread	Sealtite	Min. Internal	Dimensions in mm						Standard	Article	Weight
NPT	Size (inch)	Bore (mm)	A	B	C	D	E	F	Package	Number	(Kg/100)
NPT 1/2"	3/8"	10,4	41	12	27	35	22	22	10	819.512.9	12,0
NPT 1/2"	1/2"	13,8	41	12	30	37	27	25	10	819.516.9	14,0
NPT 3/4"	3/4"	17,4	-	12	36	-	-	-	5	838.520.9	23,5
NPT 1"	1"	23,4	-	13	46	-	-	-	5	838.526.9	42,0



## Anaconda **hygienic design**, mirror-polished “elbow food fitting” for Anaconda Sealbite.

Anaconda hygienically designed mirror polished elbow fittings can be used with all types of Anaconda Sealbite (except CNP) and offer a high corrosion resistance. Because of the special mirror-polished treatment these fittings are specifically smooth and give a good protection especially for the pharmaceutical and food industry. The mirror polished treatment reduces the risk of bacterial formation and permits easy cleaning.



### **Material & Construction:**

**Construction:** Nickel plated brass fitting, consisting of 4 parts (counter nut, clamping ring, ferrule and body).

**Material:** Counter nut, body and ferrule are nickel plated brass with exception of size 3/8" till 1" where the ferrule is from galvanised steel. Clamping ring and inserts are made from PA6 red for ISO metric.

**Temperature:** -45 °C till +105 °C continuous.

**Protection class:** IP 67 (dust-proof, water-tight).

**Colour:** Metal.

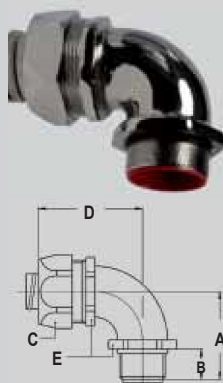

### ISO 90° fitting, male, mirror-polished nickel plated brass.



Thread	Sealtite	Min. Internal	Dimensions in mm					Standard	Article	Weight
ISO	Size (inch)	Bore (mm)	A	B	C	D	F	Package	Number	(Kg/100)
M16 x 1,5	5/16"	8,3	32	12	26	42	22	10	818.915.1	8,2
M20 x 1,5	5/16"	8,3	33	13	26	42	22	10	818.914.1	8,4
M16 x 1,5	3/8"	10,2	32	12	26	42	22	10	818.916.1	8,2
M20 x 1,5	3/8"	10,2	33	13	26	42	22	10	818.917.1	8,4
M20 x 1,5	1/2"	13,9	36	13	29	43	27	10	818.920.1	12,6
M25 x 1,5	3/4"	18,5	43	15	35	48	33	5	818.925.1	19,2
M32 x 1,5	1"	23,8	48	15	45	59	42	5	818.932.1	31,6

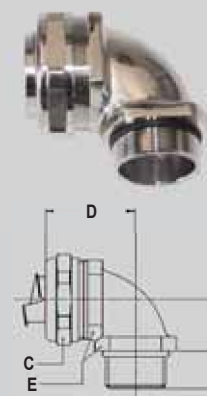

### ISO 90° fitting, compact, male, nickel plated brass.



Thread	Sealtite	Min. Internal	Dimensions in mm					Standard	Article	Weight
ISO	Size (inch)	Bore (mm)	A	B	C	D	E	Package	Number	(Kg/100)
M40 x 1,5	1.1/4"	33,3	46	13	53	53	52	2	712.940.1	40,1
M50 x 1,5	1.1/2"	38,0	52	14	62	57	60	2	712.950.1	57,5
M63 x 1,5	2"	49,0	62	16	76	68	72	2	712.963.1	90,6