

Plug union, straight

STV-GE M5-AG 6

Part no.:10.08.02.00201

<https://www.schmalz.com/10.08.02.00201>

Homepage > Vacuum Technology for Automation > Vacuum Components > Filters and Connections > Hoses and Connectors > Screw in Push Fittings > STV-GE M5-AG 6

Push-in Fitting, straight



Thread G1: M5-M
 External hose diameter: 6 mm
 Material: Brass
 Surface: nickel plated
 Ambient temperature: -20 ... 80 °C

Design Data

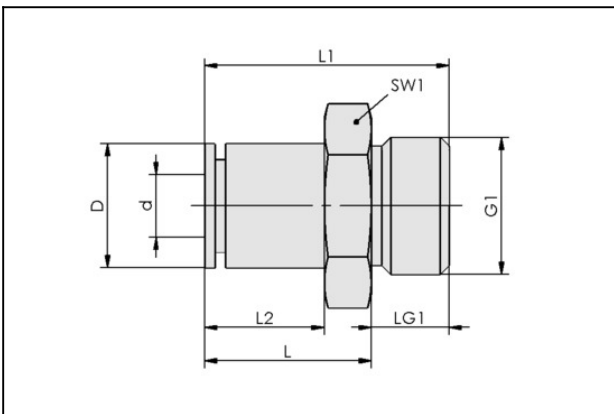

Attribute	Value
d	6 mm
D	9.9 mm
dn	2 mm
G1	M5-AG
L	18.8 mm
L1	23.3 mm
L2	14.3 mm
LG1	4.5 mm
SW1	10 mm

Accessories

Plug union, straight

STV-GE M5-AG 6

Part no.:10.08.02.00201

<https://www.schmalz.com/10.08.02.00201>

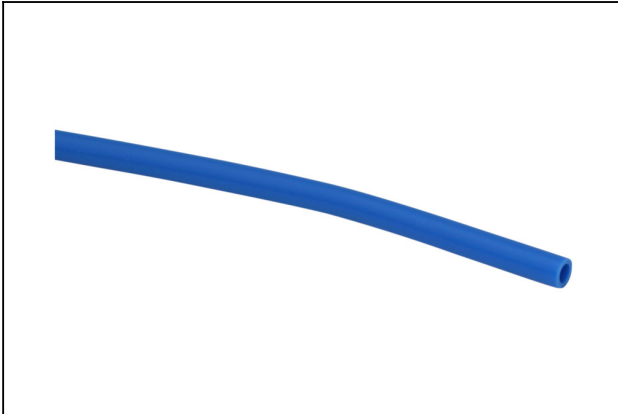

VSL 6-4 PE

Part no.10.07.09.00014

Hose for vacuum and compressed-air systems

External diameter D: 6 mm

Internal diameter d: 4 mm

Length (max): 100 m

Material: PE

Installation radius (min): 35 mm

Pressure range (operating pressure):

-0.95 ... 10.00 bar

Ambient temperature: -30 ... 70 °C



VSL 6-4 PTFE

Part no.10.07.09.00157

Hose for vacuum and compressed-air systems

External diameter D: 6 mm

Internal diameter d: 4 mm

Length (max): 50 m

Material: Polytetrafluorethylene

Installation radius (min): 35 mm

Colour: natur

Ambient temperature: -190 ... 260 °C



VSL 6-4 PU

Part no.10.07.09.00002

Hose for vacuum and compressed-air systems

External diameter D: 6 mm

Internal diameter d: 4 mm

Length (max): 500 m

Material: PU

Installation radius (min): 35 mm

Pressure range (operating pressure):

-0.95 ... 10.00 bar

Ambient temperature: -20 ... 90 °C