



PRODUCTS DATASHEET

FRM系列 SeriesP型 AC 690/700V

母线连接式快速熔断器

Busbar connection type quick fuse

产品规格书

Technical Data Sheet



1. 规格型号 Overview

- 1.1 额定电压 Rated voltage : AC690/700V
- 1.2 功能等级 Functional level : aR
- 1.3 分断能力 Rated breaking capacity : AC=100kA

2. 符合标准及规范 Standards: IEC60269-4 GB/T13539.4

3. 产品外形尺寸 Dimension

型号 Model	尺码 Size	安装方式 Installation	额定电压(V) Rated voltage	额定电流(A) Rated current	尺寸Dimension(mm)							
					A(max)	B	D	E	F	G	H	
FRM	30	P51(K)	IEC/UL AC690/700V	40~630	50	51	43(59)	43	M8	5	17	
	31	P51(K)		200~800 * 550V 900	50	51	50(69)	50	M8	8	20	
	32	P51(K)		400~1250 * 600V 1100/1250	50	51	60(77)	60	M10	10	24	
	33	P51(K)		500~2000 * 600V 1800 * 550V 2000	50	51	75(92)	75	M12	12	40	

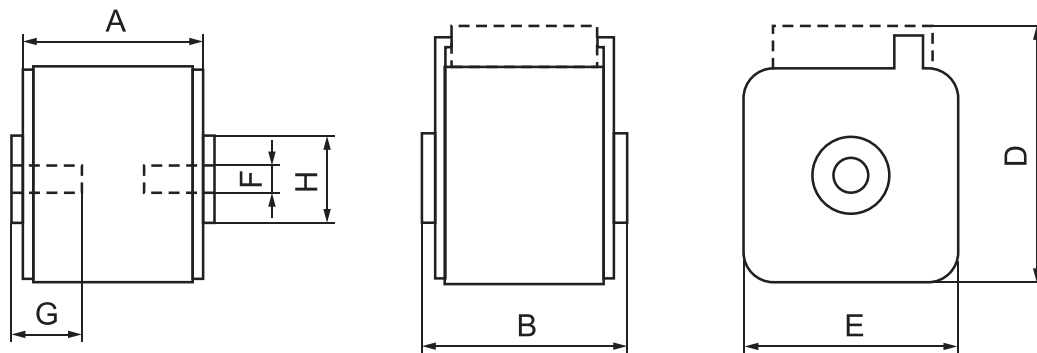

型号 Model	尺寸 Size	安装方式 Installation	额定电压(V) Rated voltage	额定电流(A) Rated current	尺寸Dimension(mm)							
					A	B	C	D	E	F	G	H
FH	33	P51	690/700	2000	211	51	99	175	53	25	30	50

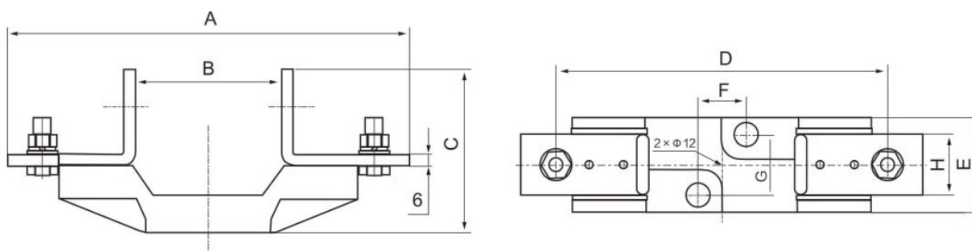

4. 产品技术参数 Technical parameters

4.1 弧前 I^2t Pre-arc/熔断 I^2t Cleaing/额定功率 Watts Loss

型号 Model	尺码 Size	安装方式 Installation	额定电压(V) Rated voltage	额定电流(A) Rated current	$I^2t(A^2S)$		功耗(W) Watts Loss	曲线图 Curve	
					弧前Pre-Arcing	熔断Clearing			
FRM	30	P51 P51K	IEC 690V	40	40	270	9	图Figure 1	
				50	77	515	11		
				63	115	770	14		
				80	185	1250	18		
				100	360	2450	21		图Figure 5
				125	550	3700	26		
				160	1100	7500	30		
				200	2200	15000	35		
				250	4200	28500	40		
				315	7000	46500	50		
				355	10000	68500	55		
				400	15000	105000	60		
				450	21000	140000	65		
				500	27000	180000	70		
	550	34000		230000	75				
	630	48500		325000	80				
	200	1650		11500	45	图Figure 2			
	250	3100		21000	55				
	315	6200		42000	58				
	355	8500		59000	60				
	400	13500		91500	65				
	450	17000		120000	70				
	500	25000		170000	72				
	550	34000		230000	75				
	630	52000		350000	80				
	700	69500		465000	85				
	800	105000		725000	95				
	400	11000		74000	65		图Figure 3		
	450	15500		105000	70				
	500	21500		145000	75				
	550	28000		190000	80				
	630	41000		275000	90				
	700	60500		405000	95				
	800	86000		575000	105				
	900	125000		840000	110				
	1000	180000		1250000	115				
	1100	245000		1600000	120				
	1250	365000		2400000	130				
	500	14000		95000	95	图Figure 4			
	550	19500		135000	100				
	630	31000		210000	105				
	700	44500		300000	110				
800	69500	465000	115						
900	100000	670000	120						
1000	140000	945000	125						
1100	190000	1300000	130						
1250	290000	1950000	140						
1400	370000	3100000	155						
1600	580000	3900000	160						
1800	880000	5250000	165						
2000	1150000	6350000	175						
			UL 700V						

4.2 熔断 I²t 修正系数K Melting I²t Correction Factor K

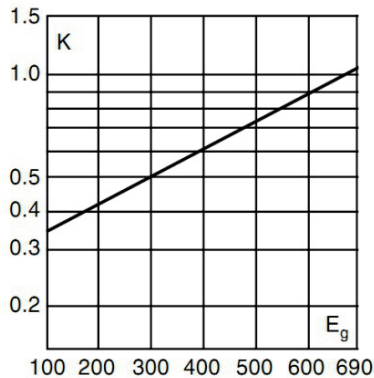

注: Eg为工作电压
Note: Eg is the working voltage

计算方法: I²t (修正) = I²t (额定) × K

Calculation Method:

I²t (correction) = I²t (rated) × K

4.3 电弧电压峰值 Peak Value of Arc Voltage

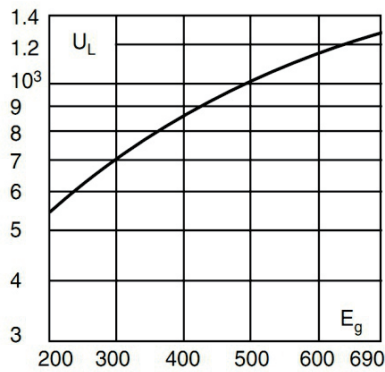

注: U_L为电弧电压峰值; Eg为工作电压; 此图为功率因数为15%的情况。

Note: U_L is the peak value of arc voltage; Eg is the working voltage; This figure shows the case when the power factor is 15%.

4.4 功耗修正系数 Power consumption correction factor Kp

额定功耗已在4.1给出, 低于额定电流的功耗可按下图计算。

The rated power consumption is given in 4.1, and the power consumption below the rated current can be calculated as shown below.

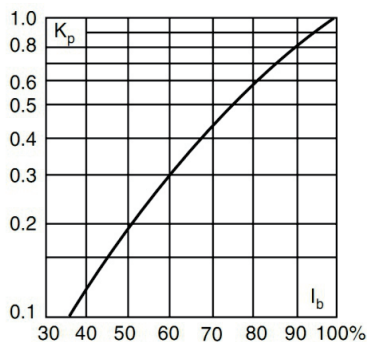

计算方法: W (修正) = W (额定) × Kp

Calculation Method:

W (correction) = W (rated) × Kp

4.5 时间-电流曲线 Time-current characteristics curves

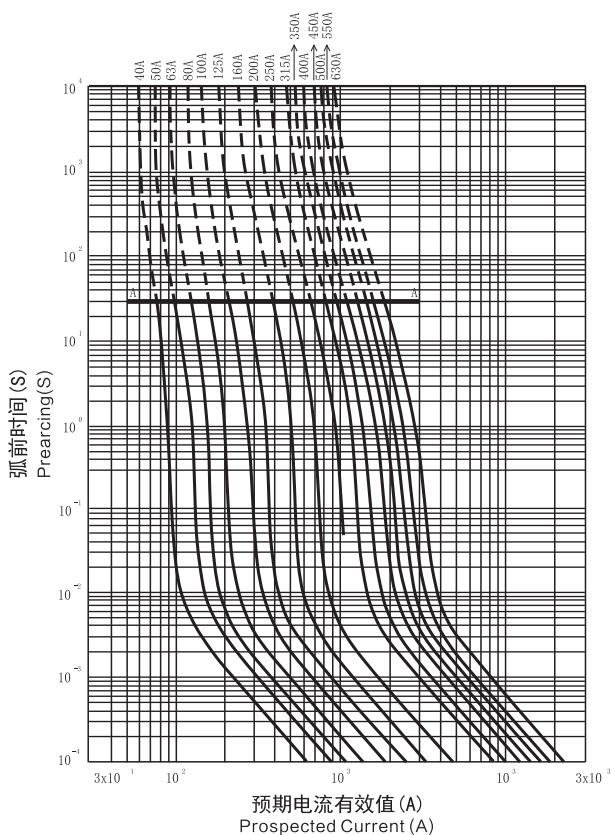

图Figure 1

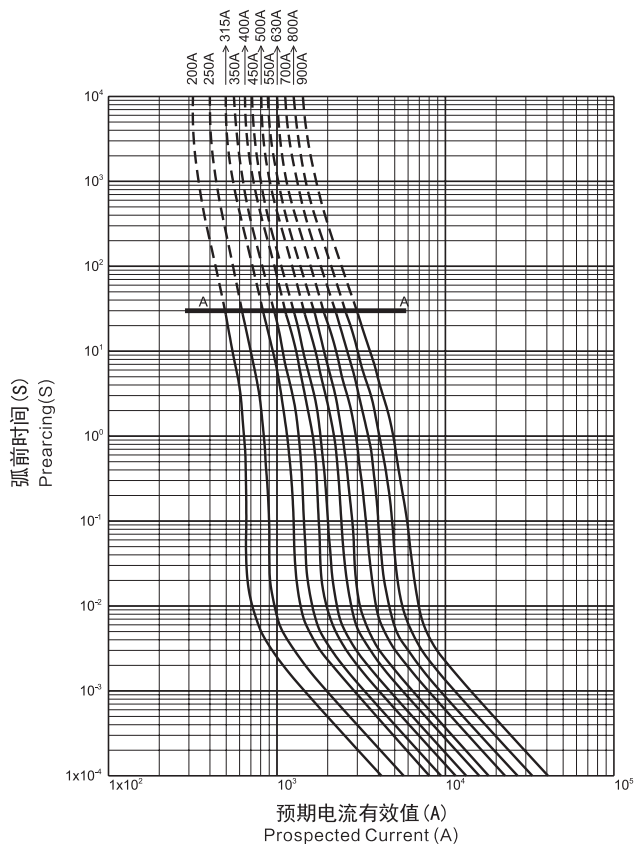

图Figure 2

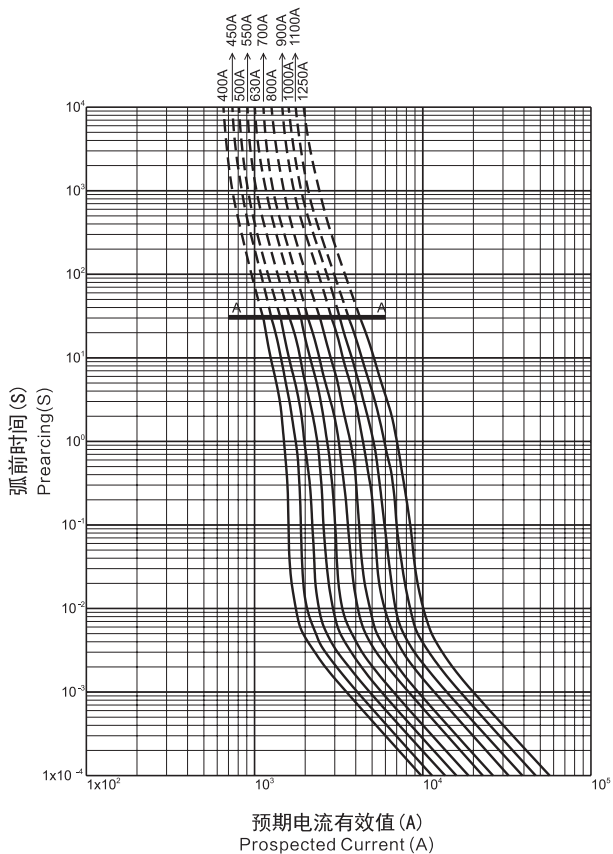

图Figure 3

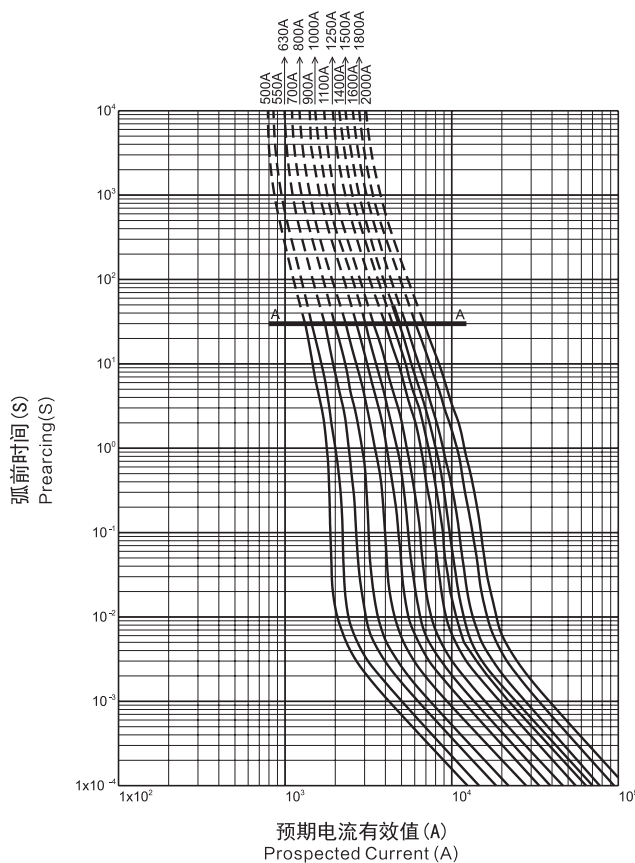

图Figure 4

4.6 截断电流特性 Cut-off current characteristics

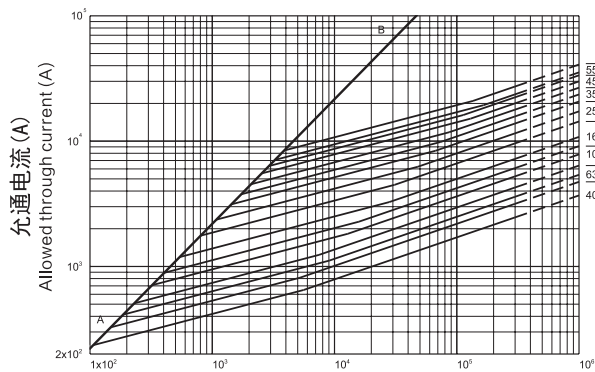

预期截断电流有效值 (A)
Prospected Cut-off Current (A)
图Figure 5

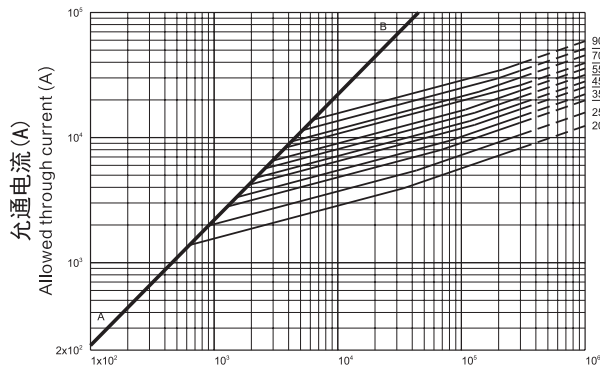

预期截断电流有效值 (A)
Prospected Cut-off Current (A)
图Figure 6

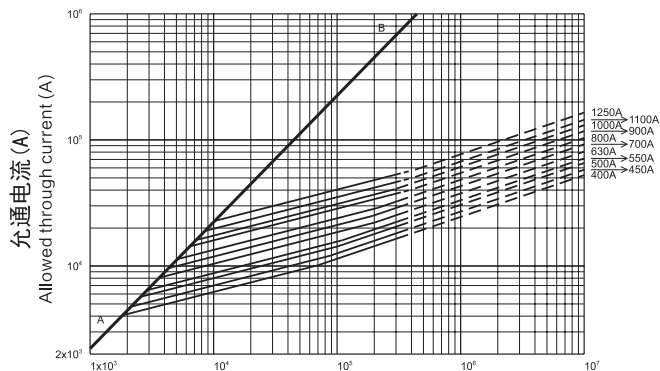

预期截断电流有效值 (A)
Prospected Cut-off Current (A)
图Figure 7

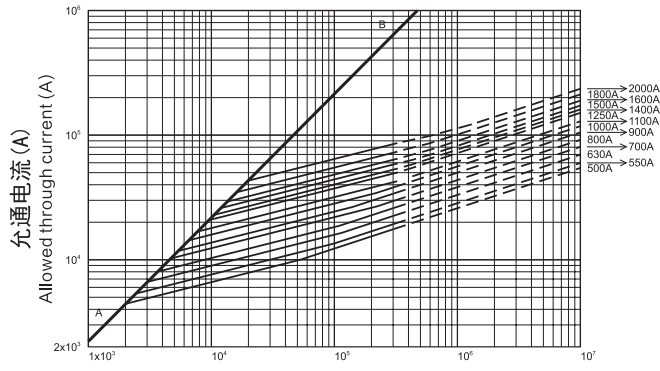

预期截断电流有效值 (A)
Prospected Cut-off Current (A)
图Figure 8

样本所述的产品资料以实物为准，若有变更本公司恕不另行通知，欢迎致电咨询。

The product information stated in the sample shall be subject to the material object.
If there is any change without prior notice, please call us for consultation.

FRSI 弗而兹电气

地址：浙江省乐清市北白象镇东大街512号
Address: 512 Dong Dajie, Beibaixiang Town, Yueqing
City, Zhejiang Province

电话(Tel): 0577-6198 6868 传真(Fax): 0577-6198 6869 网站(Web): <http://www.frsidq.com>

