

Motor GM37-520-18315-86-21D

Art.-Nr.: 860532

Specification :

Item	Unit	Specification
Rated voltage	V _{DC}	12.0
Gear Ratio		1/86
Rotation		CW
Motor Position		All position in horizontal
Temperature	°C	0~30
Humidity	%	30~95
• Performance of Motor		
No-load Speed	rpm	7.500±10%
No-load Current	mA	55 (max.)
Stall Current	mA	1500 (max.)
Stall Torque	g.cm	190
• Performance of Gear motor		
Output Speed	rpm	85±10%
No-load Current	mA	100 (max.)
Stall Current	mA	1500 (max.)
Stall Torque	kg.cm	14.0
Rated Torque	g.cm	2500
Rated Current	mA	300 (max.)
Noise	dB	52
• The Dimension		
The Outside Shaft Length	mm	21
Shaft End Play	mm	0.05-0.50
Screw Size		M3 (allowed the depth 3mm)
Dia of Shaft	mm	Ø6-D12mm

Motor GM37-520-18315-86-21D

Art.-Nr.: 860532

Dimensions :

(Unit : mm)

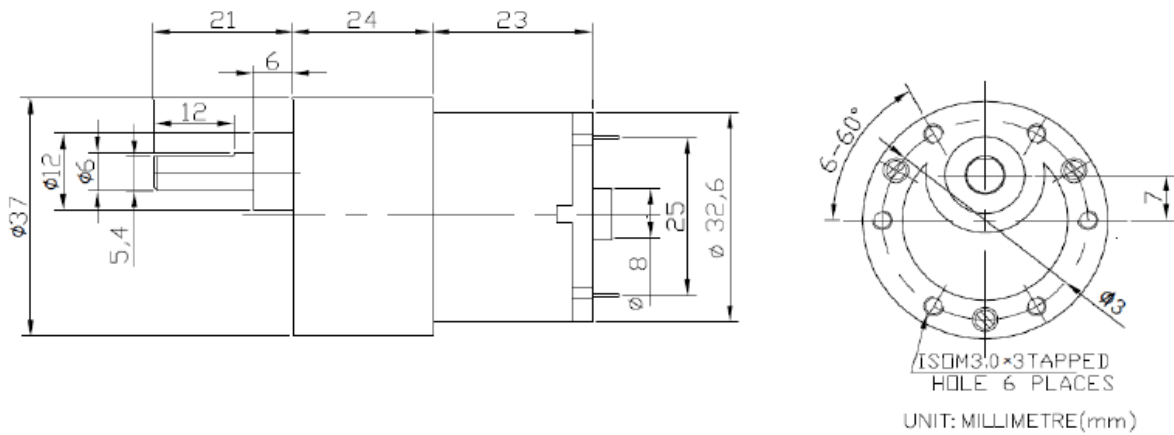

Curve Drawings :

